

# C13 Weldable Half Coupler



## CERTIFICERINGER



## FUNKTIONER

Designed for connecting reinforcing bar perpendicular to structural steel sections or plates

Internally taper threaded on one end, with the other end prepared for welding

Machined from weldable grades of steel

Slim design maintains concrete cover

## SPECIFIKATIONER

**Finish:** Plain

**Materiale:** Stål

Table 1/2

Katalognummer	Rebar Size, Metric	Rebar Size, US	Rebar Size, Canada	Diameter 1 (Ø1)	Diameter 2 (Ø2)	Length (L)
EL12C13N	12 mm	#4	10M	20 mm	11 mm	40mm
EL16C13N	16 mm	#5	15M	25 mm	18 mm	45mm
EL14C13N	14 mm			25 mm	18 mm	42mm

Katalognummer	Rebar Size, Metric	Rebar Size, US	Rebar Size, Canada	Diameter 1 (Ø1)	Diameter 2 (Ø2)	Length (L)
EL18C13N	18 mm			30 mm	24 mm	50mm
EL20C13N	20 mm	#6	20M	30 mm	22 mm	59mm
EL22C13N	22 mm	#7		35 mm	16 mm	65mm
EL28C13N	28 mm	#9	30M	40 mm	16 mm	74mm
EL25C13N	25 mm	#8	25M	40 mm	24 mm	68mm
EL36C13N	36 mm	#11	35M	50 mm	22 mm	87mm
EL32C13N	32 mm	#10		50 mm	32 mm	75mm
EL43TC13N	43 mm	#14	45M	60 mm	25 mm	110mm
EL50TC13N	50 mm			70 mm	29 mm	117mm
EL38C13N	38 mm			60 mm	38 mm	85mm
EL40C13N	40 mm			60 mm	32 mm	91mm
EL57TC13N	57 mm	#18	55M	80 mm	32 mm	133mm

Table 2/2

Katalognummer	Bar Depth (BD)	Unit Weight	Pakke mængde	Certificeringer
EL12C13N	19mm	0.06 kg	285	RISE
EL16C13N	24mm	0.11 kg	150	RISE
EL14C13N	21mm	0.12 kg	150	RISE
EL18C13N	29mm	0.2 kg	56	
EL20C13N	35mm	0.22 kg	56	RISE
EL22C13N	37mm	0.32 kg	48	
EL28C13N	42mm	0.41 kg	48	
EL25C13N	40mm	0.45 kg	30	RISE
EL36C13N	52mm	0.74 kg	30	
EL32C13N	45mm	0.75 kg	14	RISE
EL43TC13N	66mm	1.37 kg	15	
EL50TC13N	70mm	1.94 kg	8	
EL38C13N	53mm	1.24 kg	14	
EL40C13N	57mm	1.25 kg	14	RISE
EL57TC13N	83mm	2.92 kg	8	

**Designed to Meet:**

AASHTO;ABNT NBR 8548:1984;ACI 318 Type 1 (125% Specified Yield);ACI 318 Type 2 (Specified Tensile);ACI 349;ACI 359;AS3600

## YDERLIGERE PRODUKTOPLYSNINGER

---

Bar dimensions and weights listed may vary by region. Coupler sizes not shown may be available by special order. Contact your nVent LENTON representative for more information.

The design of the weld, the selection of electrode, and other relevant choices depend on the chemical and physical properties of the structural steel to which the couplers are welded. Engineers who design assemblies should adhere to all appropriate regulations.

## DIAGRAMS

---

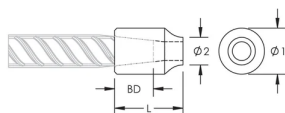

## ADVARSEL

---

nVent-produkter skal kun installeres og anvendes som angivet i nVents produktvejledninger og træningsmaterialer. Vejledninger er tilgængelige på [www.nvent.com](http://www.nvent.com) og hos din nVent kundeservicerepræsentant. Forkert installation, misbrug, fejlanvendelse eller anden undladelse af fuldt ud at følge nVents instruktioner og advarsler kan medføre funktionsfejl, materielle skader, alvorlige personskader eller død og/eller ugyldiggøre din garanti.

### North America

+1.800.753.9221

Option 1 – Customer Care

Option 2 – Technical

Support

### Europe

Netherlands:

+31 800-0200135

France:

+33 800 901 793

### Europe

Germany:

800 1890272

Other Countries:

+31 13 5835404

### APAC

Shanghai:

+ 86 21 2412 1618/19

Sydney:

+61 2 9751 8500



Vores kraftfulde portefølje af mærker:

**CADDY**

**ERICO**

**HOFFMAN**

**ILSCO**

**SCHROFF**

**TRACHTE**