

# Front Panel, Shielded, Bottom Hinged

U-profile front panel bottom hinged for textile gasket.



## CERTIFICERINGER



## FUNKTIONER

U-profile front panel can be unhinged at 135° (not RatiopacPRO) opening angle

Enables mounting on horizontal rails

Shielded, U front panel with textile EMC gasket

Suitable for subracks (EuropacPRO) and cases (RatiopacPRO, PropacPRO, CompacPRO)

## SPECIFIKATIONER

<b>Dybde (D):</b>	2.5mm
<b>Materiale:</b>	Aluminium
<b>Finish:</b>	Anodized; Passivated
<b>Accessory Type:</b>	Front panel
<b>Product Type:</b>	Front Panel
<b>Type:</b>	Front Panel without Handle

Table 1/2

Katalognummer	Rack Height	Rack Width	Pakke mængde	Mounting	Gasket Type	Front Finish
20848-599	3U	42HP	1	Hinged, Bottom	Textile EMC	Anodized
20848-604	6U	84HP	1	Hinged, Bottom	Textile EMC	Anodized

Katalognummer	Rack Height	Rack Width	Pakke mængde	Mounting	Gasket Type	Front Finish
20848-608	3U	28HP	1	Hinged, Bottom	Textile EMC	Anodized
20848-605	4U	42HP	1	Hinged, Bottom	Textile EMC	Anodized
20848-602	6U	42HP	1	Hinged, Bottom	Textile EMC	Anodized
20848-601	3U	84HP	1	Hinged, Bottom	Textile EMC	Anodized
20848-607	4U	84HP	1	Hinged, Bottom	Textile EMC	Anodized
20848-606	4U	63HP	1	Hinged, Bottom	Textile EMC	Anodized
20848-600	3U	63HP	1	Hinged, Bottom	Textile EMC	Anodized
20848-696	6U	28HP	1	Hinged, Bottom	Textile EMC	Anodized
20848-603	6U	63HP	1	Hinged, Bottom	Textile EMC	Anodized

Table 2/2

Katalognummer	Rear Finish	Treated Edges	Complies With	EMC Shielding	Højde (H)	Bredde (W)
20848-599	Conductive	No	IEC 60297-3-101, IEEE 1101.1/10	No (Retrofittable)	128.4mm	213mm
20848-604	Conductive	No	IEC 60297-3-101, IEEE 1101.1/10	No (Retrofittable)	261.8mm	426.4mm
20848-608	Conductive	No	IEC 60297-3-101, IEEE 1101.1/10	No (Retrofittable)	128.4mm	141.9mm
20848-605	Conductive	No	IEC 60297-3-101, IEEE 1101.1/10	No (Retrofittable)	172.9mm	213mm
20848-602	Conductive	No	IEC 60297-3-101, IEEE 1101.1/10	No (Retrofittable)	261.8mm	213mm
20848-601	Conductive	No	IEC 60297-3-101, IEEE 1101.1/10	No (Retrofittable)	128.4mm	426.4mm
20848-607	Conductive	No	IEC 60297-3-101, IEEE 1101.1/10	No (Retrofittable)	172.9mm	426.4mm
20848-606	Conductive	No	IEC 60297-3-101, IEEE 1101.1/10	No (Retrofittable)	172.9mm	319.7mm
20848-600	Conductive	No	IEC 60297-3-101, IEEE 1101.1/10	No (Retrofittable)	128.4mm	319.7mm

Katalognummer	Rear Finish	Treated Edges	Complies With	EMC Shielding	Højde (H)	Bredde (W)
20848-696	Conductive	No	IEC 60297-3-101, IEEE 1101.1/10	No (Retrofittable)	261.8mm	141.9mm
20848-603	Conductive	No	IEC 60297-3-101, IEEE 1101.1/10	No (Retrofittable)	261.8mm	319.7mm

## YDERLIGERE PRODUKTOPLYSNINGER

Front panel can be removed in opened position (> 135°).

## DIAGRAMS

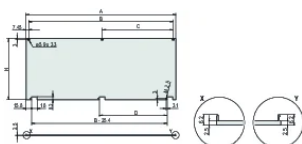

## ADVARSEL

nVent-produkter skal kun installeres og anvendes som angivet i nVents produktvejledninger og træningsmaterialer. Vejledninger er tilgængelige på [www.nvent.com](http://www.nvent.com) og hos din nVent kundeservicerepræsentant. Forkert installation, misbrug, fejlanvendelse eller anden unndladelse af fuldt ud at følge nVents instruktioner og advarsler kan medføre funktionsfejl, materielle skader, alvorlige personskader eller død og/eller ugyldiggøre din garanti.

### North America

All locations  
+1.763.422.2661  
Chat with us:  
[nvent.com/schroff](http://nvent.com/schroff)

### Europe

Straubenhardt, Germany  
+49.7082.794.0  
Betschdorf, France  
+33.3.88.90.64.90  
Warsaw, Poland  
+48.22.209.98.35  
Assago, Italy  
+39.02.932.7141  
Chat with us:  
[nvent.com/schroff](http://nvent.com/schroff)

### Asia

Shanghai, China  
+86.21.2412.6943  
Qingdao, China  
+86.532.8771.6101  
Singapore  
+65.6768.5800  
Shin-Yokohama, Japan  
+81.45.476.0271  
Chat with us:  
[nvent.com/schroff](http://nvent.com/schroff)

### Middle East & India

Dubai, United Arab Emirates  
+971.4.378.1700  
Bangalore, India  
+91.80.6715.2001  
Istanbul, Turkey  
+90.216.250.7374  
Chat with us:  
[nvent.com/schroff](http://nvent.com/schroff)



Vores kraftfulde portefølje af mærker:

**CADDY ERICO HOFFMAN ILSCO SCHROFF TRACHTE**