

# Disconnecting Link

## Data Solutions



### FEATURES

Allows for quick and easy disconnection of the earthing system to facilitate testing of the earth in isolation

High conductivity, hard drawn, electrolytic tough pitch copper per EN 13601

Includes halogen-free polyamide insulators, stainless steel (EN 1.4401) hardware and mounting brackets

### SPECIFICATIONS

**Material:** Copper

**Complies With:** IEC® EN 62561-1:2017 Class H

Table 1/2

Catalog Number	Finish	Thread Size (TS)	Height (H)	Length (L)	Width 1 (W1)	Width 2 (W2)
DLINKT	Tinned	M10	90mm	125mm	100mm	50mm
DLINKC	Bare	M10	90mm	125mm	100mm	50mm

Table 2/2

Catalog Number	Thickness (T)	Unit Weight
DLINKT	6mm	0.77kg
DLINKC	6mm	0.77kg

## ADDITIONAL PRODUCT DETAILS

---

Tinned finish is 8 microns according to ASTM B545 Service Class "C" for corrosive environments.

## DIAGRAMS

---

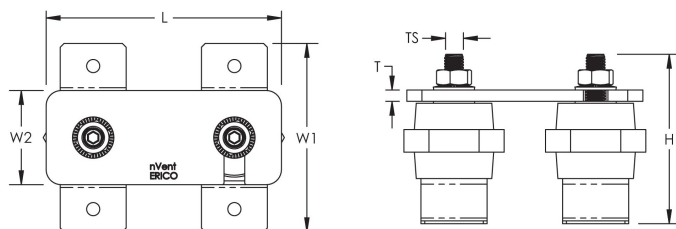

## WARNING

---

nVent products shall be installed and used only as indicated in nVent's product instruction sheets and training materials. Instruction sheets are available at [www.nvent.com](http://www.nvent.com) and from your nVent customer service representative. Improper installation, misuse, misapplication or other failure to completely follow nVent's instructions and warnings may cause product malfunction, property damage, serious bodily injury and death and/or void your warranty.



Our powerful portfolio of brands:

**CADDY ERICO HOFFMAN ILSCO SCHROFF TRACHTE**