

# Solid Copper Ground Rod, Pointed

## Power Utilities

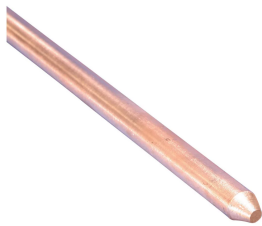

### CERTIFICATIONS



### FEATURES

Solid copper ground rods made of high conductive hard drawn bare copper

### SPECIFICATIONS

Table 1/1

Catalog Number	Material	Tensile Strength	Ground Rod Diameter, Nominal	Ground Rod Diameter, Actual (Ø)	Length (L)	Unit Weight
LPC700	Copper	290MPa min	0.5in	12.7mm	2.44mm	2.76kg

### ADDITIONAL PRODUCT DETAILS

Due to the inherent softness of the copper material, special consideration should be given when driving this product into the soil.

## DIAGRAMS

---

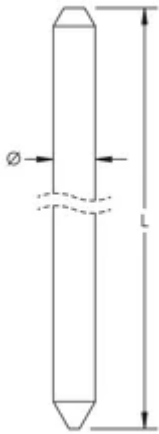

## WARNING

---

nVent products shall be installed and used only as indicated in nVent's product instruction sheets and training materials. Instruction sheets are available at [www.nvent.com](http://www.nvent.com) and from your nVent customer service representative. Improper installation, misuse, misapplication or other failure to completely follow nVent's instructions and warnings may cause product malfunction, property damage, serious bodily injury and death and/or void your warranty.



Our powerful portfolio of brands:

**CADDY ERICO HOFFMAN ILSCO SCHROFF TRACHTE**