

C12 Weldable Half Coupler, 36 mm, #11, 35M

CATALOG NUMBER

EL36C12EE



FEATURES

Designed for connecting reinforcing bar perpendicular to structural steel sections or plates

Internally taper threaded on one end, with the other end prepared for welding

Machined from weldable grades of steel

PRODUCT ATTRIBUTES

Article Number: 151200

Material: Steel

Finish: Plain

Rebar Size, Metric: 36 mm

Rebar Size, US: #11

Rebar Size, Canada: 35M

Diameter 1 (Ø1): 60 mm

Diameter 2 (Ø2): 31 mm

Length (L): 65mm

Bar Depth (BD): 53mm

Unit Weight: 0.83 kg

Package Quantity: 25

ADDITIONAL PRODUCT DETAILS

Bar dimensions and weights listed may vary by region. Coupler sizes not shown may be available by special order. Contact your nVent LENTON representative for more information.

The design of the weld, the selection of electrode, and other relevant choices depend on the chemical and physical properties of the structural steel to which the couplers are welded. Engineers who design assemblies should adhere to all appropriate regulations.

Suffix "EE" has been added to some part numbers to clarify design version among regions.

DIAGRAMS

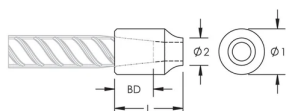

WARNING

nVent products shall be installed and used only as indicated in nVent's product instruction sheets and training materials. Instruction sheets are available at www.nvent.com and from your nVent customer service representative. Improper installation, misuse, misapplication or other failure to completely follow nVent's instructions and warnings may cause product malfunction, property damage, serious bodily injury and death and/or void your warranty.

North America

+1.800.753.9221

Option 1 – Customer Care

Option 2 – Technical

Support

Europe

Netherlands:

+31 800-0200135

France:

+33 800 901 793

Europe

Germany:

800 1890272

Other Countries:

+31 13 5835404

APAC

Shanghai:

+ 86 21 2412 1618/19

Sydney:

+61 2 9751 8500



Our powerful portfolio of brands:

CADDY

ERICO

HOFFMAN

ILSCO

SCHROFF

TRACHTE