

Compression Straight Lug



FEATURES

Tin plated for corrosion prevention

Annealed copper eases the crimping operation

Optimized sizes to the most efficient electrical conductivity

Best mechanical behavior (vibration/pull-out); DIN EN 61373 Class 1B "Railway Applications"

Markings on barrel for crimping

Consistent material thickness, precise diameter and accurate cable fit; DIN46235

SPECIFICATIONS

Material: Copper

Finish: Tinned

Table 1/2

Catalog Number	Article Number	Lug/Connector Type	Conductor Size	Hole Size (HS)	Length (L)	Width (W)
PKS5010H	715113	Heavy-Duty DIN46235	1/0 Stranded, 50 mm ² Stranded	10.5 mm	65mm	21 mm
RKS612T	716650	Standard	6 mm ² Stranded	13 mm	41mm	19 mm
PKS24012H	715127	Heavy-Duty DIN46235	240 mm ² Stranded, 500 kcmil Stranded	13 mm	108mm	42 mm

Catalog Number	Article Number	Lug/Connector Type	Conductor Size	Hole Size (HS)	Length (L)	Width (W)
RKS12012H	715121	Standard	120 mm ² Stranded, 250 kcmil Stranded	13 mm	65mm	28 mm
RKS18512T	716662	Standard	185 mm ² Stranded, 350 kcmil Stranded	13 mm	83mm	35 mm
RKS15012T	716660	Standard	150 mm ² Stranded, 300 kcmil Stranded	13 mm	72mm	31 mm
RKS050019H	716546	Standard	300 mm ² Stranded, 600 kcmil Stranded	13 mm	109mm	43 mm
PKS1612H	715111	Heavy-Duty DIN46235	#5 Stranded, 16 mm ² Stranded	13 mm	49mm	18 mm
RKS1612T	716652	Standard	#5 Stranded, 16 mm ² Stranded	13 mm	45mm	19 mm
PKS18512H	715123	Heavy-Duty DIN46235	185 mm ² Stranded, 350 kcmil Stranded	13 mm	98mm	37 mm
RKS9512T	716657	Standard	4/0 Stranded, 95 mm ² Stranded	13 mm	62mm	26 mm
PKS12014H	715116	Heavy-Duty DIN46235	120 mm ² Stranded, 250 kcmil Stranded	15 mm	88mm	32 mm
PKS30020H	715136	Heavy-Duty DIN46235	300 mm ² Stranded, 600 kcmil Stranded	15 mm	119mm	46 mm
PKS18516H	715124	Heavy-Duty DIN46235	185 mm ² Stranded, 350 kcmil Stranded	15 mm	101mm	37 mm
PKS15016H	715122	Heavy-Duty DIN46235	150 mm ² Stranded, 300 kcmil Stranded	15 mm	97mm	34 mm
PKS40020H	715138	Heavy-Duty DIN46235	400 mm ² Stranded, 800 kcmil Stranded	15 mm	140mm	54 mm
PKS24016H	715128	Heavy-Duty DIN46235	240 mm ² Stranded, 500 kcmil Stranded	15 mm	111mm	42 mm
RKS12016T	716659	Standard	120 mm ² Stranded, 250 kcmil Stranded	17 mm	67mm	28 mm

Catalog Number	Article Number	Lug/Connector Type	Conductor Size	Hole Size (HS)	Length (L)	Width (W)
RKS24016T	716664	Standard	240 mm ² Stranded, 500 kcmil Stranded	17 mm	93mm	39 mm
RKS30016T	716665	Standard	300 mm ² Stranded, 600 kcmil Stranded	17 mm	101mm	43 mm

Table 2/2

Catalog Number	Article Number	Lug/Connector Type	Conductor Size	Hole Size (HS)	Length (L)	Width (W)
RKS9516T	716658	Standard	4/0 Stranded, 95 mm ² Stranded	17 mm	66mm	26 mm
RKS18516T	716663	Standard	185 mm ² Stranded, 350 kcmil Stranded	17 mm	83mm	35 mm
PKS30016H	715129	Heavy-Duty DIN46235	300 mm ² Stranded, 600 kcmil Stranded	17 mm	119mm	46 mm
RKS40016T	716666	Standard	400 mm ² Stranded, 800 kcmil Stranded	17 mm	114mm	49 mm
RKS15016T	716661	Standard	150 mm ² Stranded, 300 kcmil Stranded	17 mm	72mm	31 mm
PKS40016H	715137	Heavy-Duty DIN46235	400 mm ² Stranded, 800 kcmil Stranded	17 mm	140mm	54 mm

Table 1/2

Catalog Number	Article Number	Tool/Die Type
PKS5010H	715113	M2M or M2H/PKM2, M3H or M3B/PKM3, MLB/PKML
RKS612T	716650	M2M or M2H/RKM2, MLB/RKML
PKS24012H	715127	M2M or M2H/PKM2, M3H or M3B/PKM3
RKS12012H	715121	M2M or M2H/RKM2, M3H or M3B/RKM3, MLB/RKML
RKS18512T	716662	M2M or M2H/RKM2, M3H or M3B/RKM3, MLB/RKML
RKS15012T	716660	M2M or M2H/RKM2, M3H or M3B/RKM3, MLB/RKML

Catalog Number	Article Number	Tool/Die Type
RKS050019H	716546	M2M or M2H/RKM2, M3H or M3B/RKM3
PKS1612H	715111	M2M or M2H/PKM2, M3H or M3B/PKM3, MLB/PKML
RKS1612T	716652	M2M or M2H/RKM2, M3H or M3B/RKM3, MLB/RKML
PKS18512H	715123	M2M or M2H/PKM2, M3H or M3B/PKM3, MLB/PKML
RKS9512T	716657	M2M or M2H/RKM2, M3H or M3B/RKM3, MLB/RKML
PKS12014H	715116	M2M or M2H/PKM2, M3H or M3B/PKM3, MLB/PKML
PKS30020H	715136	M2M or M2H/PKM2, M3H or M3B/PKM3
PKS18516H	715124	M2M or M2H/PKM2, M3H or M3B/PKM3, MLB/PKML
PKS15016H	715122	M2M or M2H/PKM2, M3H or M3B/PKM3, MLB/PKML
PKS40020H	715138	M4FP/PKM4, MLB
PKS24016H	715128	M2M or M2H/PKM2, M3H or M3B/PKM3
RKS12016T	716659	M2M or M2H/RKM2, M3H or M3B/RKM3, MLB/RKML
RKS24016T	716664	M2M or M2H/RKM2, M3H or M3B/RKM3, MLB/RKML
RKS30016T	716665	M2M or M2H/RKM2, M3H or M3B/RKM3

Table 2/2

Catalog Number	Article Number	Tool/Die Type
RKS9516T	716658	M2M or M2H/RKM2, M3H or M3B/RKM3, MLB/RKML
RKS18516T	716663	M2M or M2H/RKM2, M3H or M3B/RKM3, MLB/RKML
PKS30016H	715129	M2M or M2H/PKM2, M3H or M3B/PKM3
RKS40016T	716666	M3H or M3B/RKM3
RKS15016T	716661	M2M or M2H/RKM2, M3H or M3B/RKM3, MLB/RKML
PKS40016H	715137	M4FP/PKM4

DIAGRAMS

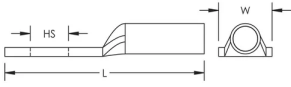

WARNING

nVent products shall be installed and used only as indicated in nVent's product instruction sheets and training materials. Instruction sheets are available at www.nvent.com and from your nVent customer service representative. Improper installation, misuse, misapplication or other failure to completely follow nVent's instructions and warnings may cause product malfunction, property damage, serious bodily injury and death and/or void your warranty.

North America

+1.800.753.9221

Option 1 – Customer Care

Option 2 – Technical

Support

Europe

Netherlands:

+31 800-0200135

France:

+33 800 901 793

Europe

Germany:

800 1890272

Other Countries:

+31 13 5835404

APAC

Shanghai:

+ 86 21 2412 1618/19

Sydney:

+61 2 9751 8500



Our powerful portfolio of brands:

CADDY

ERICO

HOFFMAN

ILSCO

SCHROFF

TRACHTE