

# Stub Down, ENT



The nVent CADDY Reinforced Conduit Stub Down (ENT) is a fast and secure method to install ENT to concrete formwork. Designed to guard against damage and prevent loss of raceways during a concrete pour, the ENT series eliminates the need for additional support during installation. Achieve confidence on-the-job knowing your conduit layout will remain in its desired configuration after the concrete deck is finished.

## FEATURES

- Integrated reinforcing stand - resists up to 200lbs of force
- Generous radius for ease of wire pull - 50% less force required
- Threaded opening designed for standard fittings
- No fish tape hang ups

## SPECIFICATIONS

Table 1/1

Catalog Number	Material	Height (H)	Length (L)	Width (W)	Thread Size (TS)
RSD075F	Polyvinylchloride	92.964 mm	215.138mm	96.012 mm	3/4" NPSM
RSD100F	Polyvinylchloride	91.694 mm	209.804mm	101.6 mm	1" NPSM

## DIAGRAMS

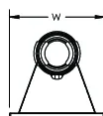
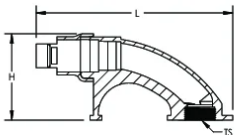

## WARNING

nVent products shall be installed and used only as indicated in nVent's product instruction sheets and training materials. Instruction sheets are available at [www.nvent.com](http://www.nvent.com) and from your nVent customer service representative. Improper installation, misuse, misapplication or other failure to completely follow nVent's instructions and warnings may cause product malfunction, property damage, serious bodily injury and death and/or void your warranty.

**North America**

+1.800.753.9221

Option 1 – Customer Care

Option 2 – Technical

Support

**Europe**

Netherlands:

+31 800-0200135

France:

+33 800 901 793

**Europe**

Germany:

800 1890272

Other Countries:

+31 13 5835404

**APAC**

Shanghai:

+ 86 21 2412 1618/19

Sydney:

+61 2 9751 8500



Our powerful portfolio of brands:

**CADDY ERICO HOFFMAN ILSCO SCHROFF TRACHTE**

