

# Connection Clamp for GND/Earthing Rail, 35 mm<sup>2</sup>

## Data Solutions

### CATALOG NUMBER

**20118-364**

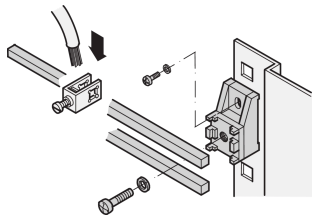

Connection Clamps available in multiple cross sections based on customer requirement.

### CERTIFICATIONS



### FEATURES

Connection Clamps available in multiple cross sections based on customer requirement

### PRODUCT ATTRIBUTES

Package Quantity: 5

Finish: Zinc Plated

Material: Steel

Product Type: Clamp

Type: Connection Clamp

Net Weight: 0.09kg

## ADDITIONAL PRODUCT DETAILS

---

Please order terminal clamps or second rail separately.

## WARNING

---

nVent products shall be installed and used only as indicated in nVent's product instruction sheets and training materials. Instruction sheets are available at [www.nvent.com](http://www.nvent.com) and from your nVent customer service representative. Improper installation, misuse, misapplication or other failure to completely follow nVent's instructions and warnings may cause product malfunction, property damage, serious bodily injury and death and/or void your warranty.



Our powerful portfolio of brands:

**CADDY   ERICO   HOFFMAN   ILSCO   SCHROFF   TRACHTE**