

Compression Straight Lug



FEATURES

Tin plated for corrosion prevention

Annealed copper eases the crimping operation

Optimized sizes to the most efficient electrical conductivity

Best mechanical behavior (vibration/pull-out); DIN EN 61373 Class 1B "Railway Applications"

Markings on barrel for crimping

Consistent material thickness, precise diameter and accurate cable fit; DIN46235

SPECIFICATIONS

Material: Copper

Finish: Tinned

Table 1/2

Catalog Number	Lug/Connector Type	Conductor Size	Hole Size (HS)	Length (L)	Width (W)	Tool/Die Type
PKS5010H	Heavy-Duty DIN46235	1/0 Stranded, 50 mm ² Stranded	10.5 mm	65mm	21 mm	M2M or M2H/PKM2, M3H or M3B/PKM3, MLB/PKML
PKS24012H	Heavy-Duty DIN46235	240 mm ² Stranded, 500 kcmil Stranded	13 mm	108mm	42 mm	M2M or M2H/PKM2, M3H or M3B/PKM3

Catalog Number	Lug/Connector Type	Conductor Size	Hole Size (HS)	Length (L)	Width (W)	Tool/Die Type
RKS3512T	Standard	#2 Stranded, 35 mm ² Stranded	13 mm	51mm	21 mm	M2M or M2H/RKM2, M3H or M3B/RKM3, MLB/RKML
RKS12012H	Standard	120 mm ² Stranded, 250 kcmil Stranded	13 mm	65mm	28 mm	M2M or M2H/RKM2, M3H or M3B/RKM3, MLB/RKML
RKS050019H	Standard	300 mm ² Stranded, 600 kcmil Stranded	13 mm	109mm	43 mm	M2M or M2H/RKM2, M3H or M3B/RKM3
RKS7012T	Standard	2/0 Stranded, 70 mm ² Stranded	13 mm	59mm	23 mm	M2M or M2H/RKM2, M3H or M3B/RKM3, MLB/RKML
RKS15012T	Standard	150 mm ² Stranded, 300 kcmil Stranded	13 mm	72mm	31 mm	M2M or M2H/RKM2, M3H or M3B/RKM3, MLB/RKML
RKS24012H	Standard	240 mm ² Stranded, 500 kcmil Stranded	13 mm	83mm	39 mm	M2M or M2H/RKM2, M3H or M3B/RKM3, MLB/RKML
RKS612T	Standard	6 mm ² Stranded	13 mm	41mm	19 mm	M2M or M2H/RKM2, MLB/RKML
PKS18512H	Heavy-Duty DIN46235	185 mm ² Stranded, 350 kcmil Stranded	13 mm	98mm	37 mm	M2M or M2H/PKM2, M3H or M3B/PKM3, MLB/PKML
RKS18512T	Standard	185 mm ² Stranded, 350 kcmil Stranded	13 mm	83mm	35 mm	M2M or M2H/RKM2, M3H or M3B/RKM3, MLB/RKML

Catalog Number	Lug/Connector Type	Conductor Size	Hole Size (HS)	Length (L)	Width (W)	Tool/Die Type
RKS1612T	Standard	#5 Stranded, 16 mm ² Stranded	13 mm	45mm	19 mm	M2M or M2H/RKM2, M3H or M3B/RKM3, MLB/RKML
RKS9512T	Standard	4/0 Stranded, 95 mm ² Stranded	13 mm	62mm	26 mm	M2M or M2H/RKM2, M3H or M3B/RKM3, MLB/RKML
PKS1612H	Heavy-Duty DIN46235	#5 Stranded, 16 mm ² Stranded	13 mm	49mm	18 mm	M2M or M2H/PKM2, M3H or M3B/PKM3, MLB/PKML
RKS2512T	Standard	#3 Stranded, 25 mm ² Stranded	13 mm	48mm	19 mm	M2M or M2H/RKM2, M3H or M3B/RKM3, MLB/RKML
PKS30020H	Heavy-Duty DIN46235	300 mm ² Stranded, 600 kcmil Stranded	15 mm	119mm	46 mm	M2M or M2H/PKM2, M3H or M3B/PKM3
PKS12014H	Heavy-Duty DIN46235	120 mm ² Stranded, 250 kcmil Stranded	15 mm	88mm	32 mm	M2M or M2H/PKM2, M3H or M3B/PKM3, MLB/PKML
PKS24016H	Heavy-Duty DIN46235	240 mm ² Stranded, 500 kcmil Stranded	15 mm	111mm	42 mm	M2M or M2H/PKM2, M3H or M3B/PKM3
PKS15016H	Heavy-Duty DIN46235	150 mm ² Stranded, 300 kcmil Stranded	15 mm	97mm	34 mm	M2M or M2H/PKM2, M3H or M3B/PKM3, MLB/PKML
PKS40020H	Heavy-Duty DIN46235	400 mm ² Stranded, 800 kcmil Stranded	15 mm	140mm	54 mm	M4FP/PKM4, MLB

Table 2/2

Catalog Number	Lug/Connector Type	Conductor Size	Hole Size (HS)	Length (L)	Width (W)	Tool/Die Type
----------------	--------------------	----------------	----------------	------------	-----------	---------------

PKS18516H	Heavy-Duty DIN46235	185 mm ² Stranded, 350 kcmil Stranded	15 mm	101mm	37 mm	M2M or M2H/PKM2, M3H or M3B/PKM3, MLB/PKML
RKS40016T	Standard	400 mm ² Stranded, 800 kcmil Stranded	17 mm	114mm	49 mm	M3H or M3B/RKM3
RKS30016T	Standard	300 mm ² Stranded, 600 kcmil Stranded	17 mm	101mm	43 mm	M2M or M2H/RKM2, M3H or M3B/RKM3
RKS12016T	Standard	120 mm ² Stranded, 250 kcmil Stranded	17 mm	67mm	28 mm	M2M or M2H/RKM2, M3H or M3B/RKM3, MLB/RKML
PKS40016H	Heavy-Duty DIN46235	400 mm ² Stranded, 800 kcmil Stranded	17 mm	140mm	54 mm	M4FP/PKM4
RKS24016T	Standard	240 mm ² Stranded, 500 kcmil Stranded	17 mm	93mm	39 mm	M2M or M2H/RKM2, M3H or M3B/RKM3, MLB/RKML
RKS9516T	Standard	4/0 Stranded, 95 mm ² Stranded	17 mm	66mm	26 mm	M2M or M2H/RKM2, M3H or M3B/RKM3, MLB/RKML
PKS30016H	Heavy-Duty DIN46235	300 mm ² Stranded, 600 kcmil Stranded	17 mm	119mm	46 mm	M2M or M2H/PKM2, M3H or M3B/PKM3
RKS15016T	Standard	150 mm ² Stranded, 300 kcmil Stranded	17 mm	72mm	31 mm	M2M or M2H/RKM2, M3H or M3B/RKM3, MLB/RKML
RKS18516T	Standard	185 mm ² Stranded, 350 kcmil Stranded	17 mm	83mm	35 mm	M2M or M2H/RKM2, M3H or M3B/RKM3, MLB/RKML

DIAGRAMS

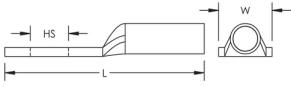

WARNING

nVent products shall be installed and used only as indicated in nVent's product instruction sheets and training materials. Instruction sheets are available at www.nvent.com and from your nVent customer service representative. Improper installation, misuse, misapplication or other failure to completely follow nVent's instructions and warnings may cause product malfunction, property damage, serious bodily injury and death and/or void your warranty.

North America

+1.800.753.9221

Option 1 – Customer Care

Option 2 – Technical

Support

Europe

Netherlands:

+31 800-0200135

France:

+33 800 901 793

Europe

Germany:

800 1890272

Other Countries:

+31 13 5835404

APAC

Shanghai:

+ 86 21 2412 1618/19

Sydney:

+61 2 9751 8500



Our powerful portfolio of brands:

CADDY

ERICO

HOFFMAN

ILSCO

SCHROFF

TRACHTE