

P8 Position Coupler, Plain



CERTIFICATIONS



FEATURES

Designed to splice the same diameter bars

Designed to splice two curved, bent or straight bars, when neither bar can be rotated and where the ongoing bar is NOT free to move in its axial direction

Adjustability in the female end of the coupler allows the coupler to extend out to meet the taper-threaded reinforcing bar

SPECIFICATIONS

Finish: Plain
Material: Steel
100% U.S. Domestic Content: Yes

Table 1/3

Catalog Number	Coupler Body Length	Rebar Size, Metric	Rebar Size, US	Rebar Size, Canada	Diameter (Ø)	Length 1 (L1)
EL16P8	Standard	16 mm	#5	15M	46 mm	130 mm
EL20P8	Standard	20 mm	#6	20M	46 mm	148 mm
EL22P8	Standard	22 mm	#7		46 mm	160 mm

Catalog Number	Coupler Body Length	Rebar Size, Metric	Rebar Size, US	Rebar Size, Canada	Diameter (Ø)	Length 1 (L1)
EL25P8	Standard	25 mm	#8	25M	46 mm	171 mm
EL28P8	Standard	28 mm	#9	30M	64 mm	175 mm
EL32P8	Standard	32 mm	#10		64 mm	186 mm
EL36P82400	Customer Specified	36 mm	#11	35M	64 mm	650 mm
EL36P84700	Customer Specified	36 mm	#11	35M	64 mm	1234 mm
EL36P8	Standard	36 mm	#11	35M	64 mm	199 mm
EL57TP8	Standard	57 mm	#18	55M	102 mm	348 mm
EL43TP8	Standard	43 mm	#14	45M	76 mm	290 mm

Table 2/3

Catalog Number	Length 2 (L2)	Bar Depth (BD)	Bar Gap 1 (BG1)	Bar Gap 2 (BG2)	Coupler Body (CB)	Unit Weight
EL16P8	170 mm	22mm	86mm	126mm	89mm	1.54 kg
EL20P8	199 mm	28mm	93mm	143mm	108mm	1.72 kg
EL22P8	215 mm	32mm	96mm	151mm	120mm	1.81 kg
EL25P8	228 mm	35mm	102mm	159mm	131mm	1.91 kg
EL28P8	235 mm	38mm	99mm	160mm	134mm	3.86 kg
EL32P8	248 mm	40mm	105mm	168mm	145mm	3.95 kg
EL36P82400	715 mm	43mm	565mm	630mm	610mm	17.1 kg
EL36P84700	1300 mm	43mm	1149mm	1214mm	1194mm	29.8 kg
EL36P8	264 mm	43mm	113mm	179mm	158mm	4.13 kg
EL57TP8	457 mm	71mm	205mm	314mm	242mm	17.19 kg
EL43TP8	384 mm	56mm	178mm	272mm	198mm	8.16 kg

Table 3/3

Catalog Number	Package Quantity	Certifications
EL16P8	10	IAPMO®-UES, LA City Approval
EL20P8	8	IAPMO®-UES, LA City Approval
EL22P8	8	IAPMO®-UES, LA City Approval
EL25P8	5	IAPMO®-UES, LA City Approval
EL28P8	4	IAPMO®-UES, LA City Approval
EL32P8	5	IAPMO®-UES, LA City Approval
EL36P82400		

Catalog Number	Package Quantity	Certifications
EL36P84700		
EL36P8	6	LA City Approval, IAPMO®-UES
EL57TP8	2	
EL43TP8	3	

Designed to Meet: AASHTO;ABNT NBR 8548:1984;ACI 318 Type 1 (125% Specified Yield);ACI 318 Type 2 (Specified Tensile);ACI 349;ACI 359;AS3600

ADDITIONAL PRODUCT DETAILS

Bar dimensions and weights listed may vary by region. Coupler sizes not shown may be available by special order. Contact your nVent LENTON representative for more information.

DIAGRAMS

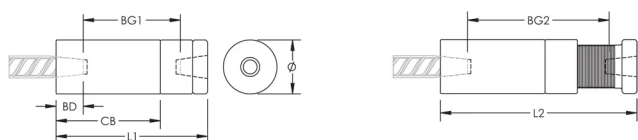

WARNING

nVent products shall be installed and used only as indicated in nVent's product instruction sheets and training materials. Instruction sheets are available at www.nvent.com and from your nVent customer service representative. Improper installation, misuse, misapplication or other failure to completely follow nVent's instructions and warnings may cause product malfunction, property damage, serious bodily injury and death and/or void your warranty.

North America

+1.800.753.9221
Option 1 – Customer Care
Option 2 – Technical Support

Europe

Netherlands:
+31 800-0200135
France:
+33 800 901 793

Europe

Germany:
800 1890272
Other Countries:
+31 13 5835404

APAC

Shanghai:
+ 86 21 2412 1618/19
Sydney:
+61 2 9751 8500



Our powerful portfolio of brands:

CADDY ERICO HOFFMAN ILSCO SCHROFF TRACHTE