

# Compression 90° Angle Lug



## FEATURES

Tin plated for corrosion prevention

Annealed copper eases the crimping operation

Optimized sizes to the most efficient electrical conductivity

Best mechanical behavior (vibration/pull-out); DIN EN 61373 Class 1B "Railway Applications"

Markings on barrel for crimping

Consistent material thickness, precise diameter and accurate cable fit; DIN46235

Flat contact surface by special angle punching process

## SPECIFICATIONS

**Angle (a):** 90 °

**Material:** Copper

**Finish:** Tinned

Table 1/2

Catalog Number	Article Number	Lug/Connector Type	Conductor Size	Hole Size (HS)	Height (H)	Length (L)
RKS1201290T	716670	Standard	120 mm <sup>2</sup> Stranded, 250 kcmil Stranded	13 mm	26 mm	48.5mm
PKS1501290H	716596	Heavy-Duty DIN46235	150 mm <sup>2</sup> Stranded, 300 kcmil Stranded	13 mm	35 mm	52mm

Catalog Number	Article Number	Lug/Connector Type	Conductor Size	Hole Size (HS)	Height (H)	Length (L)
RKS1851290T	716674	Standard	185 mm <sup>2</sup> Stranded, 350 kcmil Stranded	13 mm	30 mm	60.5mm
PKS1851290H	716598	Heavy-Duty DIN46235	185 mm <sup>2</sup> Stranded, 350 kcmil Stranded	13 mm	40 mm	58mm
RKS2401290T	716676	Standard	240 mm <sup>2</sup> Stranded, 500 kcmil Stranded	13 mm	35 mm	66mm
RKS1501290T	716672	Standard	150 mm <sup>2</sup> Stranded, 300 kcmil Stranded	13 mm	30 mm	51mm
RKS4001290	716680	Standard	400 mm <sup>2</sup> Stranded, 800 kcmil Stranded	13 mm	44 mm	76.5mm
PKS1201290H	716594	Heavy-Duty DIN46235	120 mm <sup>2</sup> Stranded, 250 kcmil Stranded	13 mm	35 mm	50mm
PKS1501690H	716597	Heavy-Duty DIN46235	150 mm <sup>2</sup> Stranded, 300 kcmil Stranded	15 mm	35 mm	58mm
RKS1201690	716671	Standard	120 mm <sup>2</sup> Stranded, 250 kcmil Stranded	15 mm	26 mm	51.5mm
PKS2401690H	716601	Heavy-Duty DIN46235	240 mm <sup>2</sup> Stranded, 500 kcmil Stranded	15 mm	40 mm	65mm
PKS1201690H	716595	Heavy-Duty DIN46235	120 mm <sup>2</sup> Stranded, 250 kcmil Stranded	15 mm	35 mm	55mm
RKS3001690	716679	Standard	300 mm <sup>2</sup> Stranded, 600 kcmil Stranded	15 mm	44 mm	73mm
RKS1501690	716673	Standard	150 mm <sup>2</sup> Stranded, 300 kcmil Stranded	15 mm	30 mm	53mm
RKS1851690	716675	Standard	185 mm <sup>2</sup> Stranded, 350 kcmil Stranded	15 mm	30 mm	60.5mm
RKS4001690	716681	Standard	400 mm <sup>2</sup> Stranded, 800 kcmil Stranded	15 mm	44 mm	76.5mm

Catalog Number	Article Number	Lug/Connector Type	Conductor Size	Hole Size (HS)	Height (H)	Length (L)
PKS1851690H	716599	Heavy-Duty DIN46235	185 mm <sup>2</sup> Stranded, 350 kcmil Stranded	15 mm	40 mm	62mm
RKS2401690	716677	Standard	240 mm <sup>2</sup> Stranded, 500 kcmil Stranded	15 mm	35 mm	66mm

Table 2/2

Catalog Number	Article Number	Width (W)	Tool/Die Type
RKS1201290T	716670	28 mm	M2M or M2H/RKM2, M3H or M3B/RKM3, MLB/RKML
PKS1501290H	716596	34 mm	M2M or M2H/PKM2, M3H or M3B/PKM3, MLB/PKML
RKS1851290T	716674	35 mm	M2M or M2H/RKM2, M3H or M3B/RKM3, MLB/RKML
PKS1851290H	716598	37 mm	M2M or M2H/PKM2, M3H or M3B/PKM3, MLB/PKML
RKS2401290T	716676	39 mm	M2M or M2H/RKM2, M3H or M3B/RKM3, MLB/RKML
RKS1501290T	716672	31 mm	M2M or M2H/RKM2, M3H or M3B/RKM3, MLB/RKML
RKS4001290	716680	49 mm	M3H or M3B/RKM3
PKS1201290H	716594	32 mm	M2M or M2H/PKM2, M3H or M3B/PKM3, MLB/PKML
PKS1501690H	716597	34 mm	M2M or M2H/PKM2, M3H or M3B/PKM3, MLB/PKML
RKS1201690	716671	28 mm	M2M or M2H/RKM2, M3H or M3B/RKM3, MLB/RKML
PKS2401690H	716601	42 mm	M2M or M2H/PKM2, M3H or M3B/PKM3
PKS1201690H	716595	32 mm	M2M or M2H/PKM2, M3H or M3B/PKM3, MLB/PKML
RKS3001690	716679	43 mm	M2M or M2H/RKM2, M3H or M3B/RKM3
RKS1501690	716673	31 mm	M2M or M2H/RKM2, M3H or M3B/RKM3, MLB/RKML
RKS1851690	716675	35 mm	M2M or M2H/RKM2, M3H or M3B/RKM3, MLB/RKML
RKS4001690	716681	49 mm	M3H or M3B/RKM3
PKS1851690H	716599	37 mm	M2M or M2H/PKM2, M3H or M3B/PKM3, MLB/PKML

Catalog Number	Article Number	Width (W)	Tool/Die Type
RKS2401690	716677	39 mm	M2M or M2H/RKM2, M3H or M3B/RKM3, MLB/RKML

## DIAGRAMS

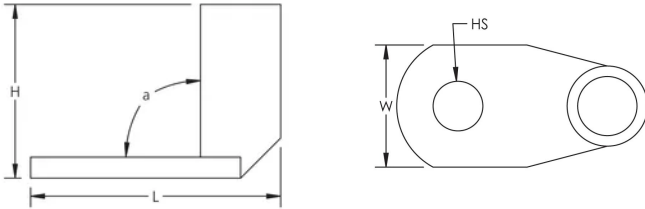

## WARNING

nVent products shall be installed and used only as indicated in nVent's product instruction sheets and training materials. Instruction sheets are available at [www.nvent.com](http://www.nvent.com) and from your nVent customer service representative. Improper installation, misuse, misapplication or other failure to completely follow nVent's instructions and warnings may cause product malfunction, property damage, serious bodily injury and death and/or void your warranty.

### North America

+1.800.753.9221  
Option 1 – Customer Care  
Option 2 – Technical  
Support

### Europe

Netherlands:  
+31 800-0200135  
France:  
+33 800 901 793

### Europe

Germany:  
800 1890272  
Other Countries:  
+31 13 5835404

### APAC

Shanghai:  
+ 86 21 2412 1618/19  
Sydney:  
+61 2 9751 8500



Our powerful portfolio of brands:

**CADDY ERICO HOFFMAN ILSCO SCHROFF TRACHTE**