

# 2 Hole Lug, GL Style

## Data Solutions



### FEATURES

Provides an efficient bolting surface for grounding and power applications

Electrolytic grade copper

For use with nVent ERICO Cadweld type GL connections only

### SPECIFICATIONS

**Material:** Copper

**Type:** NEMA®

**Finish:** Tinned

Table 1/2

Catalog Number	Article Number	Height (H)	Length (L)	Width (W)	Thickness (T)	A
B122CE	183660	11.18mm	81.03mm	25.4mm	3.18mm	15.9mm
B122DE		11.18mm	82.55mm	25.4mm	4.76mm	15.9mm

Table 2/2

Catalog Number	Article Number	B	Hole Size (HS)	Angle (a)	Equivalent Conductor Size
B122CE	183660	44.45mm	14.29mm	90°	80.63mm <sup>2</sup>
B122DE		44.45mm	14.29mm	90°	120.94mm <sup>2</sup>

## ADDITIONAL PRODUCT DETAILS

---

For sizes not listed, contact us.

## DIAGRAMS

---

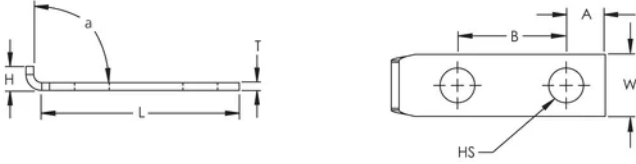

## WARNING

---

nVent products shall be installed and used only as indicated in nVent's product instruction sheets and training materials. Instruction sheets are available at [www.nvent.com](http://www.nvent.com) and from your nVent customer service representative. Improper installation, misuse, misapplication or other failure to completely follow nVent's instructions and warnings may cause product malfunction, property damage, serious bodily injury and death and/or void your warranty.



Our powerful portfolio of brands:

**CADDY ERICO HOFFMAN ILSCO SCHROFF TRACHTE**