

# Compression Straight Lug



## FEATURES

Tin plated for corrosion prevention

Annealed copper eases the crimping operation

Optimized sizes to the most efficient electrical conductivity

Best mechanical behavior (vibration/pull-out); DIN EN 61373 Class 1B "Railway Applications"

Markings on barrel for crimping

Consistent material thickness, precise diameter and accurate cable fit; DIN46235

## SPECIFICATIONS

**Material:** Copper

**Finish:** Tinned

Table 1/2

Catalog Number	Article Number	Lug/Connector Type	Conductor Size	Hole Size (HS)	Length (L)	Width (W)
PKS1610H		Heavy-Duty DIN46235	#6 Stranded, 16 mm <sup>2</sup> Stranded	10.5 mm	48mm	17 mm
RKS050019H	716546	Standard	300 mm <sup>2</sup> Stranded, 600 kcmil Stranded	13 mm	109mm	43 mm
RKS7012T	716656	Standard	2/0 Stranded, 70 mm <sup>2</sup> Stranded	13 mm	59mm	23 mm

Table 2/2

Catalog Number	Article Number	Tool/Die Type
PKS1610H		M2M or M2H/RKM2, M3H or M3B/RKM3, MLB/RKML
RKS050019H	716546	M2M or M2H/RKM2, M3H or M3B/RKM3
RKS7012T	716656	M2M or M2H/RKM2, M3H or M3B/RKM3, MLB/RKML

## DIAGRAMS

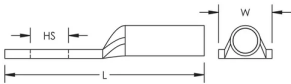

## WARNING

nVent products shall be installed and used only as indicated in nVent's product instruction sheets and training materials. Instruction sheets are available at [www.nvent.com](http://www.nvent.com) and from your nVent customer service representative. Improper installation, misuse, misapplication or other failure to completely follow nVent's instructions and warnings may cause product malfunction, property damage, serious bodily injury and death and/or void your warranty.

### North America

+1.800.753.9221  
 Option 1 – Customer Care  
 Option 2 – Technical  
 Support

### Europe

Netherlands:  
 +31 800-0200135  
 France:  
 +33 800 901 793

### Europe

Germany:  
 800 1890272  
 Other Countries:  
 +31 13 5835404

### APAC

Shanghai:  
 + 86 21 2412 1618/19  
 Sydney:  
 +61 2 9751 8500



Our powerful portfolio of brands:

**CADDY ERICO HOFFMAN ILSCO SCHROFF TRACHTE**