

2-2 Hole Open Corner Angle Bracket



FEATURES

Used to create metal frames with nVent CADDY Eristrut channels

SPECIFICATIONS

Finish: Hot-Dip Galvanized

Material: Steel

Table 1/2

Catalog Number	Article Number	Angle (a)	B	C	Hole Size (HS)	Thickness (T)
ZWA220	387980	45 °	87 mm	87 mm	14	6
ZW220	313700	45 °	87 mm	87 mm	14	6

Table 2/2

Catalog Number	Article Number	Screw Diameter (Sc)	Screw Length (L)	Screw Included
ZWA220	387980			No
ZW220	313700	10	25mm	Yes

DIAGRAMS

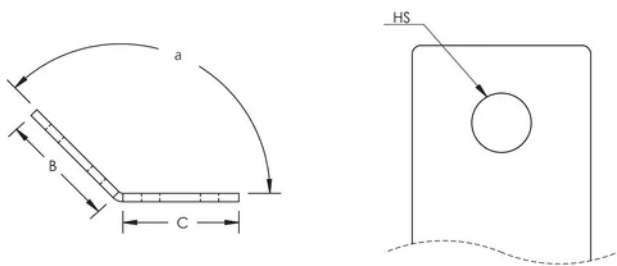

WARNING

nVent products shall be installed and used only as indicated in nVent's product instruction sheets and training materials. Instruction sheets are available at www.nvent.com and from your nVent customer service representative. Improper installation, misuse, misapplication or other failure to completely follow nVent's instructions and warnings may cause product malfunction, property damage, serious bodily injury and death and/or void your warranty.

North America

+1.800.753.9221
Option 1 – Customer Care
Option 2 – Technical
Support

Europe

Netherlands:
+31 800-0200135
France:
+33 800 901 793

Europe

Germany:
800 1890272
Other Countries:
+31 13 5835404

APAC

Shanghai:
+ 86 21 2412 1618/19
Sydney:
+61 2 9751 8500



Our powerful portfolio of brands:

CADDY ERICO HOFFMAN ILSCO SCHROFF TRACHTE

