

Front Panel, Unshielded, Bottom Hinged

Unshielded front panel bottom hinged.



CERTIFICATIONS



FEATURES

Front panel can be unhinged at 135° (not RatiopacPRO) opening angle

Enables mounting on horizontal rails

SPECIFICATIONS

- Depth (D):** 2.5mm
- Material:** Aluminum
- Finish:** Anodized
- Accessory Type:** Front panel
- Product Type:** Front Panel
- Type:** Front Panel without Handle

Table 1/2

Catalog Number	Rack Height	Rack Width	Package Quantity	Mounting	Front Finish	Rear Finish
20838-280	3U	28HP	1	Hinged, Bottom	Anodized	Conductive
20838-271	3U	42HP	1	Hinged, Bottom	Anodized	Conductive
20838-274	6U	42HP	1	Hinged, Bottom	Anodized	Conductive
20838-279	4U	84HP	1	Hinged, Bottom	Anodized	Conductive

Catalog Number	Rack Height	Rack Width	Package Quantity	Mounting	Front Finish	Rear Finish
20838-272	3U	63HP	1	Hinged, Bottom	Anodized	Conductive
20838-275	6U	63HP	1	Hinged, Bottom	Anodized	Conductive
20838-278	4U	63HP	1	Hinged, Bottom	Anodized	Conductive
20838-277	4U	42HP	1	Hinged, Bottom	Anodized	Conductive
20838-276	6U	84HP	1	Hinged, Bottom	Anodized	Conductive
20838-273	3U	84HP	1	Hinged, Bottom	Anodized	Conductive

Table 2/2

Catalog Number	Treated Edges	Complies With	EMC Shielding	Height (H)	Width (W)
20838-280	No	IEC 60297-3-101, IEEE 1101.1/10	No	128.4mm	141.9mm
20838-271	No	IEC 60297-3-101, IEEE 1101.1/10	No	128.4mm	213mm
20838-274	No	IEC 60297-3-101, IEEE 1101.1/10	No	261.8mm	213mm
20838-279	No	IEC 60297-3-101, IEEE 1101.1/10	No	172.9mm	426.4mm
20838-272	No	IEC 60297-3-101, IEEE 1101.1/10	No	128.4mm	319.7mm
20838-275	No	IEC 60297-3-101, IEEE 1101.1/10	No	261.8mm	319.7mm
20838-278	No	IEC 60297-3-101, IEEE 1101.1/10	No	172.9mm	319.7mm
20838-277	No	IEC 60297-3-101, IEEE 1101.1/10	No	172.9mm	213mm
20838-276	No	IEC 60297-3-101, IEEE 1101.1/10	No	261.8mm	426.4mm
20838-273	No	IEC 60297-3-101, IEEE 1101.1/10	No	128.4mm	426.4mm

ADDITIONAL PRODUCT DETAILS

Front panel can be removed in opened position (> 135°).

DIAGRAMS

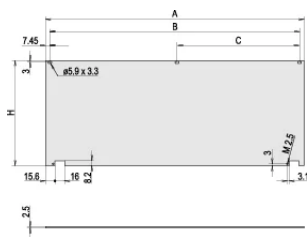

WARNING

nVent products shall be installed and used only as indicated in nVent's product instruction sheets and training materials. Instruction sheets are available at www.nvent.com and from your nVent customer service representative. Improper installation, misuse, misapplication or other failure to completely follow nVent's instructions and warnings may cause product malfunction, property damage, serious bodily injury and death and/or void your warranty.

North America

All locations
+1.763.422.2661
Chat with us:
nvent.com/schroff

Europe

Straubenhardt, Germany
+49.7082.794.0
Betschdorf, France
+33.3.88.90.64.90
Warsaw, Poland
+48.22.209.98.35
Assago, Italy
+39.02.932.7141
Chat with us:
nvent.com/schroff

Asia

Shanghai, China
+86.21.2412.6943
Qingdao, China
+86.532.8771.6101
Singapore
+65.6768.5800
Shin-Yokohama, Japan
+81.45.476.0271
Chat with us:
nvent.com/schroff

Middle East & India

Dubai, United Arab Emirates
+971.4.378.1700
Bangalore, India
+91.80.6715.2001
Istanbul, Turkey
+90.216.250.7374
Chat with us:
nvent.com/schroff



Our powerful portfolio of brands:

CADDY ERICO HOFFMAN ILSCO SCHROFF TRACHTE