

C14 Two-Piece Weldable Coupler, 12 mm, #4, 10M

CATALOG NUMBER

EL12C14N



nVent LENTON C14 Two-Piece Weldable Couplers provide a quick and easy solution for connecting reinforcing steel bar (rebar) perpendicular to structural steel sections or plates. The coupler is internally taper threaded on one end with the other end or exterior surface prepared for welding. The C14 Two-Piece weldable coupler materials have been optimized to facilitate simple welding processes. Typically, the coupler and mating steel sections will not require pre- or post-heating to aid in the welding process.

CERTIFICATIONS



FEATURES

Machined from weldable grades of steel

J-groove chamfer reduces required weld area

Easy to weld

PRODUCT ATTRIBUTES

Rebar Size, Metric: 12 mm

Rebar Size, US: #4

Rebar Size, Canada: 10M

Hex Width (W): 30 mm

Diameter 2 (Ø2): 30 mm

Diameter 3 (Ø3): 24mm

Length (L): 70mm

Bar Depth (BD): 19mm

Unit Weight: 0.36 kg

Designed to Meet: AASHTO;ABNT NBR 8548:1984;ACI 318 Type 1 (125% Specified Yield);ACI 318 Type 2 (Specified Tensile);ACI 349;ACI 359;AS3600

Package Quantity: 50

ADDITIONAL PRODUCT DETAILS

Bar dimensions and weights listed may vary by region. Coupler sizes not shown may be available by special order. Contact your nVent LENTON representative for more information.

The design of the weld, the selection of electrode, and other relevant choices depend on the chemical and physical properties of the structural steel to which the couplers are welded. Engineers who design assemblies should adhere to all appropriate regulations.

DIAGRAMS

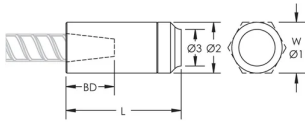

WARNING

nVent products shall be installed and used only as indicated in nVent's product instruction sheets and training materials. Instruction sheets are available at www.nvent.com and from your nVent customer service representative. Improper installation, misuse, misapplication or other failure to completely follow nVent's instructions and warnings may cause product malfunction, property damage, serious bodily injury and death and/or void your warranty.

North America

+1.800.753.9221

Option 1 – Customer Care

Option 2 – Technical

Support

Europe

Netherlands:

+31 800-0200135

France:

+33 800 901 793

Europe

Germany:

800 1890272

Other Countries:

+31 13 5835404

APAC

Shanghai:

+ 86 21 2412 1618/19

Sydney:

+61 2 9751 8500



Our powerful portfolio of brands:

CADDY

ERICO

HOFFMAN

ILSCO

SCHROFF

TRACHTE