

# Large Washer



## SPECIFICATIONS

**Finish:** Electrogalvanized  
**Material:** Steel

Table 1/1

Catalog Number	Article Number	Hole Size (HS)	Diameter (Ø)	Thickness (T)
0121028	584597	10.5 mm	28 mm	2 mm
0120628	585200	6.4 mm	28 mm	2 mm
0120828	584596	8.4 mm	28 mm	2 mm
0121740	584612	17 mm	40 mm	3 mm
0120840	584600	8.4 mm	40 mm	3 mm
0121040	584610	10.5 mm	40 mm	3 mm
0121340	584611	13 mm	40 mm	3 mm

## DIAGRAMS

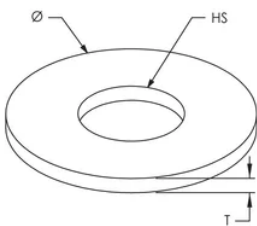

## WARNING

---

nVent products shall be installed and used only as indicated in nVent's product instruction sheets and training materials. Instruction sheets are available at [www.nvent.com](http://www.nvent.com) and from your nVent customer service representative. Improper installation, misuse, misapplication or other failure to completely follow nVent's instructions and warnings may cause product malfunction, property damage, serious bodily injury and death and/or void your warranty.

### North America

+1.800.753.9221

Option 1 – Customer Care

Option 2 – Technical

Support

### Europe

Netherlands:

+31 800-0200135

France:

+33 800 901 793

### Europe

Germany:

800 1890272

Other Countries:

+31 13 5835404

### APAC

Shanghai:

+ 86 21 2412 1618/19

Sydney:

+61 2 9751 8500



Our powerful portfolio of brands:

**CADDY ERICO HOFFMAN ILSCO SCHROFF TRACHTE**

