

# Dual Terminal Adaptor

## Data Solutions



### FEATURES

For connection of nVent ERICO System 3000 air terminals to dual runs of nVent ERICO Ericore downconductor

### SPECIFICATIONS

Table 1/1

| Catalog Number | Material                        | Depth (D) | Height (H) | Width (W) | Unit Weight |
|----------------|---------------------------------|-----------|------------|-----------|-------------|
| TERMDUALCOUP   | Stainless Steel 316 (EN 1.4401) | 68mm      | 80mm       | 220mm     | 3kg         |

### DIAGRAMS

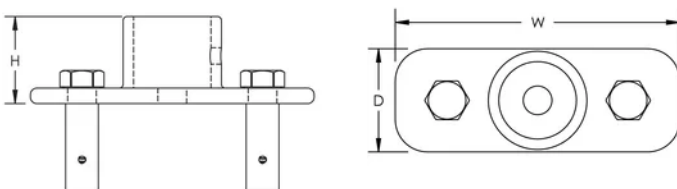

## WARNING

---

nVent products shall be installed and used only as indicated in nVent's product instruction sheets and training materials. Instruction sheets are available at [www.nvent.com](http://www.nvent.com) and from your nVent customer service representative. Improper installation, misuse, misapplication or other failure to completely follow nVent's instructions and warnings may cause product malfunction, property damage, serious bodily injury and death and/or void your warranty.



Our powerful portfolio of brands:

**CADDY   ERICO   HOFFMAN   ILSCO   SCHROFF   TRACHTE**