

# Flat Washer



## FEATURES

Use under the head of a bolt or nut in order to distribute the fastener load over a wider surface area

## SPECIFICATIONS

**Complies With:** DIN 933

Table 1/1

| Catalog Number | Article Number | Material                        | Finish             | Hole Size (HS) | Diameter (Ø) | Thickness (T) |
|----------------|----------------|---------------------------------|--------------------|----------------|--------------|---------------|
| 01108S4        | 592490         | Stainless Steel 304 (EN 1.4301) |                    | 8.4 mm         | 16 mm        | 1.6 mm        |
| 01108EG        | 592400         | Steel                           | Electrogalvanized  | 8.4 mm         | 16 mm        | 1.6 mm        |
| 01106EG        | 592390         | Steel                           | Electrogalvanized  | 6.4 mm         | 12 mm        | 1.6 mm        |
| 01106S4        | 592480         | Stainless Steel 304 (EN 1.4301) |                    | 6.4 mm         | 12 mm        | 1.6 mm        |
| 01110HD        | 592415         | Steel                           | Hot-Dip Galvanized | 10.5 mm        | 21 mm        | 2 mm          |
| 01110S4        | 592500         | Stainless Steel 304 (EN 1.4301) |                    | 10.5 mm        | 20 mm        | 2 mm          |

| Catalog Number | Article Number | Material                        | Finish             | Hole Size (HS) | Diameter (Ø) | Thickness (T) |
|----------------|----------------|---------------------------------|--------------------|----------------|--------------|---------------|
| 01110EG        | 592410         | Steel                           | Electrogalvanized  | 10.5 mm        | 20 mm        | 2 mm          |
| 01112EG        | 592420         | Steel                           | Electrogalvanized  | 13 mm          | 24 mm        | 2.5 mm        |
| 01112HD        | 592425         | Steel                           | Hot-Dip Galvanized | 13 mm          | 24 mm        | 2.5 mm        |
| 01112S4        | 592510         | Stainless Steel 304 (EN 1.4301) |                    | 13 mm          | 24 mm        | 2.5 mm        |
| 01116EG        | 400448         | Steel                           | Electrogalvanized  | 17 mm          | 30 mm        | 3 mm          |

## DIAGRAMS

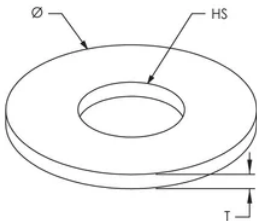

## WARNING

nVent products shall be installed and used only as indicated in nVent's product instruction sheets and training materials. Instruction sheets are available at [www.nvent.com](http://www.nvent.com) and from your nVent customer service representative. Improper installation, misuse, misapplication or other failure to completely follow nVent's instructions and warnings may cause product malfunction, property damage, serious bodily injury and death and/or void your warranty.

### North America

+1.800.753.9221  
Option 1 – Customer Care  
Option 2 – Technical Support

### Europe

Netherlands:  
+31 800-0200135  
France:  
+33 800 901 793

### Europe

Germany:  
800 1890272  
Other Countries:  
+31 13 5835404

### APAC

Shanghai:  
+ 86 21 2412 1618/19  
Sydney:  
+61 2 9751 8500



Our powerful portfolio of brands:

**CADDY ERICO HOFFMAN ILSCO SCHROFF TRACHTE**

