

# Heavy Duty Pipe Clamp, Painted, Red Oxide, 20.5–22 mm OD, 1/2" Pipe, 15 DN

## CATALOG NUMBER

**SSG022RO**



## FEATURES

For high static requirements in industrial construction

Suitable for fix point applications

## PRODUCT ATTRIBUTES

Article Number: 574600

Material: Steel

Finish: Painted;Red Oxide

Outer Diameter (OD): 20.5 - 22 mm

Pipe Size: 1/2"

NB/DN: 15

Hole Size (HS): 6.6 mm

Screw Diameter (Sc): 6 mm

Screw Length (L): 20mm

Static Load: 1000N

Width (W): 23 mm

Thickness (T): 3 mm

A: 46 mm

## ADDITIONAL PRODUCT DETAILS

Static load refers to a complete set of Heavy Duty Pipe Clamps held in place with indicated screws per ISO 4014 and corresponding hex nuts per ISO 4032 (for further information, please refer to Standard SSG 7075E).

## DIAGRAMS

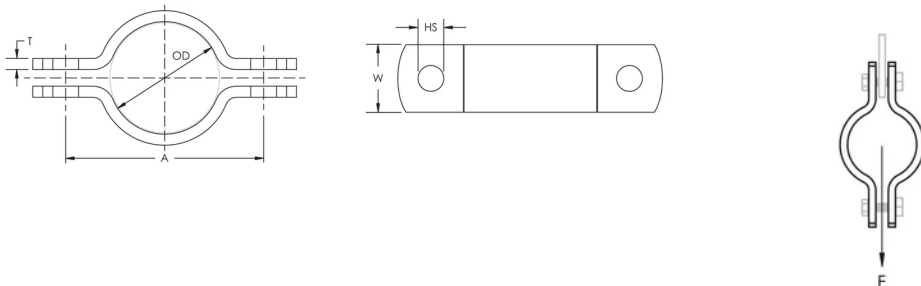

## WARNING

nVent products shall be installed and used only as indicated in nVent's product instruction sheets and training materials. Instruction sheets are available at [www.nvent.com](http://www.nvent.com) and from your nVent customer service representative. Improper installation, misuse, misapplication or other failure to completely follow nVent's instructions and warnings may cause product malfunction, property damage, serious bodily injury and death and/or void your warranty.

### North America

+1.800.753.9221

Option 1 – Customer Care

Option 2 – Technical

Support

### Europe

Netherlands:

+31 800-0200135

France:

+33 800 901 793

### Europe

Germany:

800 1890272

Other Countries:

+31 13 5835404

### APAC

Shanghai:

+ 86 21 2412 1618/19

Sydney:

+61 2 9751 8500



Our powerful portfolio of brands:

CADDY

ERICO

HOFFMAN

ILSCO

SCHROFF

TRACHTE

