

C2/C3J Weldable Half-Coupler



FEATURES

Designed for connecting reinforcing bar perpendicular to structural steel sections or plates

Internally taper threaded on one end, with the other end prepared for welding

Machined from weldable grades of steel

Available in customer specified lengths

SPECIFICATIONS

Finish:	Plain
Coupler Body Length:	Standard
Material:	Steel

Table 1/2

Catalog Number	Rebar Size, Metric	Rebar Size, US	Rebar Size, Canada	Diameter 1 (Ø1)	Diameter 2 (Ø2)	Length (L)
EL12C2N	12 mm	#4	10M	20 mm	11 mm	30mm
EL16C2N	16 mm	#5	15M	25 mm	14 mm	35mm
EL20C3JN	20 mm	#6	20M	32 mm	22 mm	55mm
EL22C3JN	22 mm	#7		32 mm	19 mm	61mm
EL18C3JN	18 mm			32 mm	22 mm	55mm
EL28C3JN	28 mm	#9	30M	40 mm	24 mm	68mm
EL25C3JN	25 mm	#8	25M	40 mm	25 mm	64mm
EL36C3JN	36 mm	#11	35M	51 mm	29 mm	75mm

Catalog Number	Rebar Size, Metric	Rebar Size, US	Rebar Size, Canada	Diameter 1 (Ø1)	Diameter 2 (Ø2)	Length (L)
EL32C3JN	32 mm	#10		51 mm	24 mm	73mm
EL40C3JN	40 mm			60 mm	36 mm	83mm
EL43TC3JN	43 mm	#14	45M	60 mm	36 mm	95mm
EL50TC3JN	50 mm			70 mm	38 mm	114mm
EL57TC3JN	57 mm	#18	55M	80 mm	44 mm	114mm

Table 2/2

Catalog Number	Bar Depth (BD)	Unit Weight	Package Quantity
EL12C2N	15mm	0.05 kg	285
EL16C2N	22mm	0.08 kg	150
EL20C3JN	28mm	0.24 kg	56
EL22C3JN	32mm	0.24 kg	48
EL18C3JN	24mm	0.26 kg	56
EL28C3JN	38mm	0.41 kg	48
EL25C3JN	34mm	0.44 kg	30
EL36C3JN	43mm	0.69 kg	30
EL32C3JN	40mm	0.7 kg	14
EL40C3JN	55mm	1.13 kg	14
EL43TC3JN	56mm	1.28 kg	15
EL50TC3JN	71mm	2 kg	8
EL57TC3JN	71mm	2.54 kg	6

Designed to Meet: AASHTO;ABNT NBR 8548:1984;ACI 318 Type 1 (125% Specified Yield);ACI 318 Type 2 (Specified Tensile);ACI 349;ACI 359;AS3600

ADDITIONAL PRODUCT DETAILS

Bar dimensions and weights listed may vary by region. Coupler sizes not shown may be available by special order. Contact your nVent LENTON representative for more information.

The design of the weld, the selection of electrode, and other relevant choices depend on the chemical and physical properties of the structural steel to which the couplers are welded. Engineers who design assemblies should adhere to all appropriate regulations.

DIAGRAMS

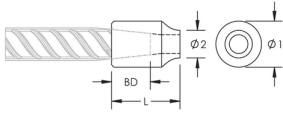

WARNING

nVent products shall be installed and used only as indicated in nVent's product instruction sheets and training materials. Instruction sheets are available at www.nvent.com and from your nVent customer service representative. Improper installation, misuse, misapplication or other failure to completely follow nVent's instructions and warnings may cause product malfunction, property damage, serious bodily injury and death and/or void your warranty.

North America

+1.800.753.9221

Option 1 – Customer Care

Option 2 – Technical

Support

Europe

Netherlands:

+31 800-0200135

France:

+33 800 901 793

Europe

Germany:

800 1890272

Other Countries:

+31 13 5835404

APAC

Shanghai:

+ 86 21 2412 1618/19

Sydney:

+61 2 9751 8500



Our powerful portfolio of brands:

CADDY

ERICO

HOFFMAN

ILSCO

SCHROFF

TRACHTE