

Compression Straight Connector



FEATURES

Tin plated for corrosion prevention

Annealed copper eases the crimping operation

Optimized sizes produce the most efficient electrical conductivity while providing superior mechanical resistance to vibration and pull out

Non-tension connectors

Heavy duty PKC-type connectors (DIN46235)

SPECIFICATIONS

Material: Copper

Finish: Tinned

Table 1/2

Catalog Number	Article Number	Lug/Connector Type	Conductor Size	Length (L)	Tool/Die Type
RKC6T	716710	Standard	6 mm ² Stranded	25mm	M2M or M2H/RKM2, MLB/RKML
RKC50T	716715	Standard	50 mm ² Stranded, 1/0 Stranded	50mm	M2M or M2H/RKM2, M3H or M3B/RKM3, MLB/RKML

Catalog Number	Article Number	Lug/Connector Type	Conductor Size	Length (L)	Tool/Die Type
PKC50H	716625	Heavy-Duty DIN46235	50 mm ² Stranded, 1/0 Stranded	56mm	M2M or M2H/PKM2, M3H or M3B/PKM3, MLB/PKML
RKC10T	716711	Standard	10 mm ² Stranded, #7 Stranded	30mm	M2M or M2H/RKM2, MLB/RKML
PKC6H	716620	Heavy-Duty DIN46235	6 mm ² Stranded	30mm	M2M or M2H/PKM2, M3H or M3B/PKM3, MLB/PKML
PKC10H	716621	Heavy-Duty DIN46235	10 mm ² Stranded, #7 Stranded	30mm	M2M or M2H/PKM2, MLB/PKML
RKC16T	716712	Standard	16 mm ² Stranded, #5 Stranded	35mm	M2M or M2H/RKM2, M3H or M3B/RKM3, MLB/RKML
RKC25T	716713	Standard	25 mm ² Stranded, #3 Stranded	40mm	M2M or M2H/RKM2, M3H or M3B/RKM3, MLB/RKML
RKC35T	716714	Standard	35 mm ² Stranded, #2 Stranded	45mm	M2M or M2H/RKM2, M3H or M3B/RKM3, MLB/RKML
PKC16H	716622	Heavy-Duty DIN46235	16 mm ² Stranded, #5 Stranded	50mm	M2M or M2H/PKM2, M3H or M3B/PKM3, MLB/PKML
PKC25H	716623	Heavy-Duty DIN46235	25 mm ² Stranded, #3 Stranded	50mm	M2M or M2H/PKM2, M3H or M3B/PKM3, MLB/PKML
PKC35H	716624	Heavy-Duty DIN46235	35 mm ² Stranded, #2 Stranded	50mm	M2M or M2H/PKM2, M3H or M3B/PKM3, MLB/PKML
RKC70T	716716	Standard	70 mm ² Stranded, 2/0 Stranded	55mm	M2M or M2H/RKM2, M3H or M3B/RKM3, MLB/RKML

Catalog Number	Article Number	Lug/Connector Type	Conductor Size	Length (L)	Tool/Die Type
PKC70H	716626	Heavy-Duty DIN46235	70 mm ² Stranded, 2/0 Stranded	56mm	M2M or M2H/PKM2, M3H or M3B/PKM3, MLB/PKML
RKC95T	716717	Standard	95 mm ² Stranded, 4/0 Stranded	60mm	M2M or M2H/RKM2, M3H or M3B/RKM3, MLB/RKML
RKC120T	716718	Standard	120 mm ² Stranded, 250 kcmil Stranded	65mm	M2M or M2H/RKM2, M3H or M3B/RKM3, MLB/RKML
PKC120H	716628	Heavy-Duty DIN46235	120 mm ² Stranded, 250 kcmil Stranded	70mm	M2M or M2H/PKM2, M3H or M3B/PKM3, MLB/PKML
RKC150T	716719	Standard	150 mm ² Stranded, 300 kcmil Stranded	70mm	M2M or M2H/RKM2, M3H or M3B/RKM3, MLB/RKML
PKC95H	716627	Heavy-Duty DIN46235	95 mm ² Stranded, 4/0 Stranded	70mm	M2M or M2H/PKM2, M3H or M3B/PKM3, MLB/PKML
RKC185T	716720	Standard	185 mm ² Stranded, 350 kcmil Stranded	75mm	M2M or M2H/RKM2, M3H or M3B/RKM3, MLB/RKML

Table 2/2

Catalog Number	Article Number	Lug/Connector Type	Conductor Size	Length (L)	Tool/Die Type
PKC150H	716629	Heavy-Duty DIN46235	150 mm ² Stranded, 300 kcmil Stranded	80mm	M2M or M2H/PKM2, M3H or M3B/PKM3, MLB/PKML
RKC240T	716721	Standard	240 mm ² Stranded, 500 kcmil Stranded	85mm	M2M or M2H/RKM2, M3H or M3B/RKM3, MLB/RKML
PKC185H	716630	Heavy-Duty DIN46235	185 mm ² Stranded, 350 kcmil Stranded	85mm	M2M or M2H/PKM2, M3H or M3B/PKM3, MLB/PKML

Catalog Number	Article Number	Lug/Connector Type	Conductor Size	Length (L)	Tool/Die Type
PKC240H	716631	Heavy-Duty DIN46235	240 mm ² Stranded, 500 kcmil Stranded	90mm	M2M or M2H/PKM2, M3H or M3B/PKM3
RKC300T	716722	Standard	300 mm ² Stranded, 600 kcmil Stranded	100mm	M2M or M2H/RKM2, M3H or M3B/RKM3
RKC400T	716723	Standard	400 mm ² Stranded, 800 kcmil Stranded	100mm	M3H or M3B/RKM3
PKC300H	716632	Heavy-Duty DIN46235	300 mm ² Stranded, 600 kcmil Stranded	100mm	M2M or M2H/PKM2, M3H or M3B/PKM3
PKC625H	716635	Heavy-Duty DIN46235	625 mm ² Stranded	160mm	M4FP/PKM4
PKC400H	716633	Heavy-Duty DIN46235	400 mm ² Stranded, 800 kcmil Stranded	160mm	M4FP/PKM4
PKC500H	716634	Heavy-Duty DIN46235	500 mm ² Stranded	160mm	M4FP/PKM4

DIAGRAMS

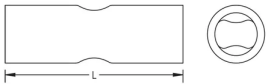

WARNING

nVent products shall be installed and used only as indicated in nVent's product instruction sheets and training materials. Instruction sheets are available at www.nvent.com and from your nVent customer service representative. Improper installation, misuse, misapplication or other failure to completely follow nVent's instructions and warnings may cause product malfunction, property damage, serious bodily injury and death and/or void your warranty.

North America

+1.800.753.9221

Option 1 – Customer Care

Option 2 – Technical

Support

Europe

Netherlands:

+31 800-0200135

France:

+33 800 901 793

Europe

Germany:

800 1890272

Other Countries:

+31 13 5835404

APAC

Shanghai:

+ 86 21 2412 1618/19

Sydney:

+61 2 9751 8500



Our powerful portfolio of brands:

CADDY

ERICO

HOFFMAN

ILSCO

SCHROFF

TRACHTE