

P9J Weldable Position Coupler



FEATURES

Designed for connecting reinforcing bar perpendicular to structural steel sections or plates when the mating bar cannot be rotated and is free to move in its axial direction

Ideal for connecting hooked reinforcing bar to structural steel elements

Internally taper threaded on one end, with the other end prepared for welding

Machined from weldable grades of steel

SPECIFICATIONS

Finish:	Plain
Material:	Steel
100% U.S. Domestic Content:	Yes

Table 1/2

Catalog Number	Rebar Size, Metric	Rebar Size, US	Rebar Size, Canada	Diameter 1 (Ø1)	Diameter 2 (Ø2)	Length 1 (L1)
EL32P9J	32 mm	#10		76 mm	60 mm	120 mm
EL20P9J	20 mm	#6	20M	51 mm	41 mm	105 mm
EL25P9J	25 mm	#8	25M	51 mm	35 mm	115 mm
EL22P9J	22 mm	#7		51 mm	38 mm	110 mm
EL28P9J	28 mm	#9	30M	76 mm	64 mm	114 mm
EL36P9J	36 mm	#11	35M	76 mm	57 mm	126 mm

Table 2/2

Catalog Number	Length 2 (L2)	Bar Depth (BD)	Coupler Body (CB)	Unit Weight	Package Quantity
EL32P9J	128 mm	40mm	80mm	2.77 kg	1
EL20P9J	114 mm	28mm	65mm	1.18 kg	1
EL25P9J	123 mm	34mm	75mm	1.22 kg	1
EL22P9J	118 mm	32mm	70mm	1.22 kg	12
EL28P9J	121 mm	38mm	73mm	2.72 kg	6
EL36P9J	134 mm	43mm	86mm	2.9 kg	6

Designed to Meet: AASHTO;ABNT NBR 8548:1984;ACI 318 Type 1 (125% Specified Yield);ACI 318 Type 2 (Specified Tensile);ACI 349;ACI 359;AS3600

ADDITIONAL PRODUCT DETAILS

Bar dimensions and weights listed may vary by region. Coupler sizes not shown may be available by special order. Contact your nVent LENTON representative for more information.

DIAGRAMS

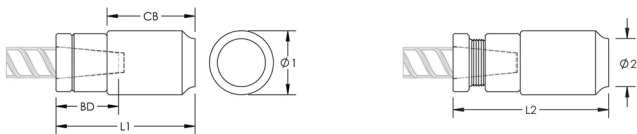

WARNING

nVent products shall be installed and used only as indicated in nVent's product instruction sheets and training materials. Instruction sheets are available at www.nvent.com and from your nVent customer service representative. Improper installation, misuse, misapplication or other failure to completely follow nVent's instructions and warnings may cause product malfunction, property damage, serious bodily injury and death and/or void your warranty.

North America

+1.800.753.9221

Option 1 – Customer Care

Option 2 – Technical

Support

Europe

Netherlands:

+31 800-0200135

France:

+33 800 901 793

Europe

Germany:

800 1890272

Other Countries:

+31 13 5835404

APAC

Shanghai:

+ 86 21 2412 1618/19

Sydney:

+61 2 9751 8500



Our powerful portfolio of brands:

CADDY

ERICO

HOFFMAN

ILSCO

SCHROFF

TRACHTE