

# Flat Washer



## FEATURES

Use under the head of a bolt or nut in order to distribute the fastener load over a wider surface area

## SPECIFICATIONS

**Complies With:** DIN 933

Table 1/1

Catalog Number	Article Number	Material	Finish	Hole Size (HS)	Diameter (Ø)	Thickness (T)
01108S4	592490	Stainless Steel 304 (EN 1.4301)		8.4 mm	16 mm	1.6 mm
01108EG	592400	Steel	Electrogalvanized	8.4 mm	16 mm	1.6 mm
01106EG	592390	Steel	Electrogalvanized	6.4 mm	12 mm	1.6 mm
01106S4	592480	Stainless Steel 304 (EN 1.4301)		6.4 mm	12 mm	1.6 mm
01110HD	592415	Steel	Hot-Dip Galvanized	10.5 mm	21 mm	2 mm
01110S4	592500	Stainless Steel 304 (EN 1.4301)		10.5 mm	20 mm	2 mm

Catalog Number	Article Number	Material	Finish	Hole Size (HS)	Diameter (Ø)	Thickness (T)
01110EG	592410	Steel	Electrogalvanized	10.5 mm	20 mm	2 mm
01112EG	592420	Steel	Electrogalvanized	13 mm	24 mm	2.5 mm
01112HD	592425	Steel	Hot-Dip Galvanized	13 mm	24 mm	2.5 mm
01112S4	592510	Stainless Steel 304 (EN 1.4301)		13 mm	24 mm	2.5 mm
01116EG	400448	Steel	Electrogalvanized	17 mm	30 mm	3 mm

## DIAGRAMS

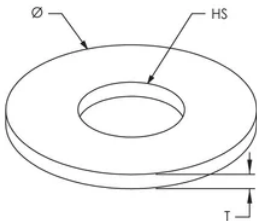

## WARNING

nVent products shall be installed and used only as indicated in nVent's product instruction sheets and training materials. Instruction sheets are available at [www.nvent.com](http://www.nvent.com) and from your nVent customer service representative. Improper installation, misuse, misapplication or other failure to completely follow nVent's instructions and warnings may cause product malfunction, property damage, serious bodily injury and death and/or void your warranty.

### North America

+1.800.753.9221  
Option 1 – Customer Care  
Option 2 – Technical Support

### Europe

Netherlands:  
+31 800-0200135  
France:  
+33 800 901 793

### Europe

Germany:  
800 1890272  
Other Countries:  
+31 13 5835404

### APAC

Shanghai:  
+ 86 21 2412 1618/19  
Sydney:  
+61 2 9751 8500



Our powerful portfolio of brands:

**CADDY ERICO HOFFMAN ILSCO SCHROFF TRACHTE**

