

# Oval Pipe Clamp with Nut



## FEATURES

Designed to support pre-insulated twin tubes and integrated power cable for solar heat collectors

Shape of clamp provides a stable attachment to wall or ceiling

## SPECIFICATIONS

**Finish:** Electrogalvanized

**Material:** Steel

Table 1/2

Catalog Number	Article Number	NB/DN	Rod Size (RS)	A	B	Width (W)
MXOVDN25EG	403800	25	M8, M10	71 mm	124 mm	20 mm
MXOVDN1618EG	401245	16, 18	M8, M10	51 mm	88 mm	20 mm
MXOVDN1012EG	401161	10, 12	M8, M10	30 mm	69 mm	20 mm
MXOVDN20EG	401246	20	M8, M10	58 mm	108 mm	20 mm
MXOVDN1215EG	401244	12, 15	M8, M10	43 mm	78 mm	20 mm

Table 2/2

Catalog Number	Article Number	Thickness (T)	Screw Diameter (Sc)	Screw Length (L)
MXOVDN25EG	403800	2 mm	6	20mm
MXOVDN1618EG	401245	2 mm	6	20mm

Catalog Number	Article Number	Thickness (T)	Screw Diameter (Sc)	Screw Length (L)
MXOVDN1012EG	401161	2 mm	6	20mm
MXOVDN20EG	401246	2 mm	6	20mm
MXOVDN1215EG	401244	2 mm	6	20mm

## DIAGRAMS

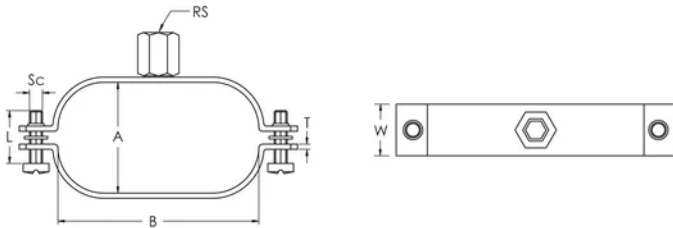

## WARNING

nVent products shall be installed and used only as indicated in nVent's product instruction sheets and training materials. Instruction sheets are available at [www.nvent.com](http://www.nvent.com) and from your nVent customer service representative. Improper installation, misuse, misapplication or other failure to completely follow nVent's instructions and warnings may cause product malfunction, property damage, serious bodily injury and death and/or void your warranty.

### North America

+1.800.753.9221  
Option 1 – Customer Care  
Option 2 – Technical  
Support

### Europe

Netherlands:  
+31 800-0200135  
France:  
+33 800 901 793

### Europe

Germany:  
800 1890272  
Other Countries:  
+31 13 5835404

### APAC

Shanghai:  
+ 86 21 2412 1618/19  
Sydney:  
+61 2 9751 8500



Our powerful portfolio of brands:

**CADDY ERICO HOFFMAN ILSCO SCHROFF TRACHTE**

