

# Adjustable I-Beam Adapter

## Data Solutions



This code-compliant Structural Attachment is part of the nVent CADDY line of innovative rigid bracing system, designed to provide superior performance and meet the highest seismic load requirements. Its innovative design allows quick and easy installation onto a wide range of steel I-Beams. It is ready to use out of the box, eliminating the need for pre-assembly or loose hardware and its snap-off bolts make inspection of seismic sway braces simple.

### CERTIFICATIONS



### FEATURES

No loose parts

No assembly required

Snap-off bolt head helps enable easy installation and inspection of seismic sway braces

Meets NFPA®-13 requirements for seismic sway bracing

FM® Specification Tested

### SPECIFICATIONS

**Material:** Steel

Table 1/2

| Catalog Number | Finish             | Flange Thickness (FT) | A           | Rod Size 1 (RS1) | Rod Size 2 (RS2) | Height (H) |
|----------------|--------------------|-----------------------|-------------|------------------|------------------|------------|
| CSBS3HDN       | Hot-Dip Galvanized | 6 – 19mm              | 100 – 215mm | 3/8" in          | 1/2" in          | 67mm       |
| CSBS4N         | Electro galvanized | 6 – 19mm              | 100 – 365mm | 3/8" in          | 1/2" in          | 67mm       |

| Catalog Number | Finish             | Flange Thickness (FT) | A           | Rod Size 1 (RS1) | Rod Size 2 (RS2) | Height (H) |
|----------------|--------------------|-----------------------|-------------|------------------|------------------|------------|
| CSBS4HDN       | Hot-Dip Galvanized | 6 – 19mm              | 100 – 365mm | 3/8" in          | 1/2" in          | 67mm       |
| CSBS3N         | Electrogalvanized  | 6 – 19mm              | 100 – 215mm | 3/8" in          | 1/2" in          | 67mm       |
| CSBS5HDN       | Hot-Dip Galvanized | 19 – 31mm             | 100 – 455mm | 3/8" in          | 1/2" in          | 79mm       |
| CSBS5N         | Electrogalvanized  | 19 – 31mm             | 100 – 455mm | 3/8" in          | 1/2" in          | 79mm       |

Table 2/2

| Catalog Number | Width (W) | Certifications  |
|----------------|-----------|---|
| CSBS3HDN       | 92mm      | FM Approved, Seismic  |
| CSBS4N         | 92mm      | AON Fire Protection, Seismic Bracing Components, FM Approved, Seismic |
| CSBS4HDN       | 92mm      | FM Approved, Seismic  |
| CSBS3N         | 92mm      | FM Approved, Seismic, AON Fire Protection, Seismic Bracing Components |
| CSBS5HDN       | 92mm      | FM Approved, Seismic  |
| CSBS5N         | 92mm      | FM Approved, Seismic, AON Fire Protection, Seismic Bracing Components |

## ADDITIONAL PRODUCT DETAILS

---

Structure Attachment and Brace Member are not included.

| UL Loads    |                              |                  |                         |                         |
|-------------|------------------------------|------------------|-------------------------|-------------------------|
| Part Number | Structure Attachment Fitting | Flange Thickness | Brace Member            | Load Rating             |
| CSBS3xxx    | CSBU1xxx                     | 6 - 8 mm         | DN25 - DN50 Sch. 40 NPS | 6672 N                  |
|             |                              | 8 - 19 mm        |                         | 7561 N                  |
|             | CSBURC12                     | 6 - 19 mm        | CSB12CBL                | 1859 N                  |
|             |                              |                  | CSB18CBL                | 3434 N                  |
|             |                              |                  | CSB36CBL                | 4893 N                  |
|             | CSBS4xxx                     | CSBU1xxx         | 6 - 8 mm                | DN25 - DN50 Sch. 40 NPS |
| 8 - 19 mm   |                              |                  | 7561 N                  |                         |
| CSBURC12    |                              | 6 - 19 mm        | CSB12CBL                | 1859 N                  |
|             |                              |                  | CSB18CBL                | 3434 N                  |
|             |                              |                  | CSB36CBL                | 4893 N                  |
| CSBS5xxx    |                              | CSBU1xxx         | 6 - 19 mm               | DN25 - DN50 Sch. 40 NPS |
|             | CSBURC12                     | 6 - 19 mm        | CSB12CBL                | 1859 N                  |
|             |                              |                  | CSB18CBL                | 3434 N                  |
|             |                              |                  | CSB36CBL                | 4893 N                  |

| FM Loads    |  |          |          |          |                       |          |          |          |
|-------------|--|----------|----------|----------|-----------------------|----------|----------|----------|
| Part Number | Horizontal Capacity per Installation Angle from Vertical |          |          |          |                       |          |          |          |
|             | Perpendicular to Structure                               |          |          |          | Parallel to Structure |          |          |          |
|             | 30°- 44°   | 45°- 59° | 60°- 74° | 75°- 90° | 30°- 44°              | 45°- 59° | 60°- 74° | 75°- 90° |
| CSBS3xxx    | 5240 N   | 9830 N   | 12580 N  | 13070 N  | 3640 N                | 6130 N   | 9250 N   | 13380 N  |
| CSBS4xxx    | 5240 N   | 9830 N   | 12580 N  | 13070 N  | 3640 N                | 6130 N   | 9250 N   | 13380 N  |
| CSBS5xxx    | 5420 N   | 9510 N   | 11470 N  | 12760 N  | 4890 N                | 8090 N   | 9740 N   | 11920 N  |

## DIAGRAMS

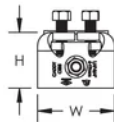
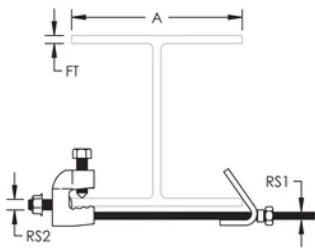

## WARNING

nVent products shall be installed and used only as indicated in nVent's product instruction sheets and training materials. Instruction sheets are available at [www.nvent.com](http://www.nvent.com) and from your nVent customer service representative. Improper installation, misuse, misapplication or other failure to completely follow nVent's instructions and warnings may cause product malfunction, property damage, serious bodily injury and death and/or void your warranty.



Our powerful portfolio of brands:

**CADDY ERICO HOFFMAN ILSCO SCHROFF TRACHTE**