

Single Hole Cable Strap



CERTIFICATIONS



FEATURES

Secures lightning protection conductors and prevents displacement

Mechanically secured with screws or nails

SPECIFICATIONS

Table 1/2

Catalog Number	Article Number	Material	Finish	Outer Diameter (OD)	Depth (D)	Width (W)
PC010C	711390	Copper		10 mm	15mm	42 mm
PC010A	711040	Aluminum		10 mm	15mm	42 mm
LPC801		Copper		11.91 mm	9.84mm	25 mm
LPC803L		Copper	Tinned	11.91 mm	12.7mm	25 mm
LPA803		Aluminum		11.91 mm	12.7mm	25 mm
LPC803		Copper		11.91 mm	12.7mm	25 mm
LPC801L		Copper	Tinned	11.91 mm	9.84mm	25 mm
PC008A	711370	Aluminum		7 mm	10mm	28 mm
LPA807		Aluminum		33 mm	31.75mm	76.71 mm

Catalog Number	Article Number	Material	Finish	Outer Diameter (OD)	Depth (D)	Width (W)
LPC807L		Copper	Tinned	33 mm	31.75mm	76.71 mm
LPC807		Copper		33 mm	31.75mm	76.71 mm
LPC805		Copper		12.7 mm	15.88mm	31.75 mm
LPA805		Aluminum		12.7 mm	15.88mm	31.75 mm
LPC805L		Copper	Tinned	12.7 mm	15.88mm	31.75 mm
LPC80538		Copper		12.7 mm	15.88mm	31.75 mm

Table 2/2

Catalog Number	Article Number	Hole Size (HS)	Certifications
PC010C	711390	7 mm	
PC010A	711040	7 mm	
LPC801		4.76 mm	E202878-Combined_CoC, E202878-Combined_CoC
LPC803L		4.76 mm	E202878-Combined_CoC, E202878-Combined_CoC
LPA803		4.76 mm	
LPC803		4.76 mm	E202878-Combined_CoC, E202878-Combined_CoC
LPC801L		4.76 mm	E202878-Combined_CoC, E202878-Combined_CoC
PC008A	711370	5 mm	
LPA807		7.14 mm	
LPC807L		7.14 mm	E202878-Combined_CoC, E202878-Combined_CoC
LPC807		7.14 mm	E202878-Combined_CoC, E202878-Combined_CoC
LPC805		7.14 mm	E202878-Combined_CoC, E202878-Combined_CoC
LPA805		7.14 mm	
LPC805L		7.14 mm	E202878-Combined_CoC, E202878-Combined_CoC
LPC80538		9.53 mm	E202878-Combined_CoC, E202878-Combined_CoC

ADDITIONAL PRODUCT DETAILS

Typically installed every 3' (0.9 m) of conductor.

DIAGRAMS

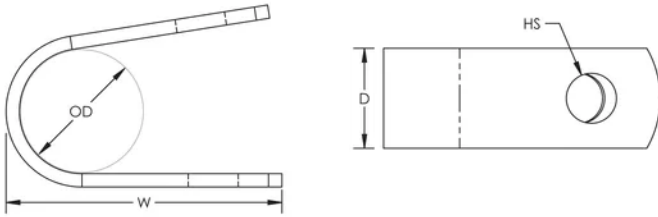

WARNING

nVent products shall be installed and used only as indicated in nVent's product instruction sheets and training materials. Instruction sheets are available at www.nvent.com and from your nVent customer service representative. Improper installation, misuse, misapplication or other failure to completely follow nVent's instructions and warnings may cause product malfunction, property damage, serious bodily injury and death and/or void your warranty.

North America

+1.800.753.9221
Option 1 – Customer Care
Option 2 – Technical
Support

Europe

Netherlands:
+31 800-0200135
France:
+33 800 901 793

Europe

Germany:
800 1890272
Other Countries:
+31 13 5835404

APAC

Shanghai:
+ 86 21 2412 1618/19
Sydney:
+61 2 9751 8500



Our powerful portfolio of brands:

CADDY ERICO HOFFMAN ILSCO SCHROFF TRACHTE