

# Compression Straight Lug

## Data Solutions



### FEATURES

Tin plated for corrosion prevention

Annealed copper eases the crimping operation

Optimized sizes to the most efficient electrical conductivity

Best mechanical behavior (vibration/pull-out); DIN EN 61373 Class 1B "Railway Applications"

Markings on barrel for crimping

Consistent material thickness, precise diameter and accurate cable fit; DIN46235

### SPECIFICATIONS

**Material:** Copper

**Finish:** Tinned

Table 1/2

Catalog Number	Article Number	Lug/Connector Type	Conductor Size	Hole Size (HS)	Length (L)	Width (W)
PKS5010H	715113	Heavy-Duty DIN46235	1/0 Stranded, 50 mm <sup>2</sup> Stranded	10.5mm	65mm	21mm
PKS1610H		Heavy-Duty DIN46235	#6 Stranded, 16 mm <sup>2</sup> Stranded	10.5mm	48mm	17mm
RKS2512T	716653	Standard	#3 Stranded, 25 mm <sup>2</sup> Stranded	13mm	48mm	19mm

CatalogNumber	Article Number	Lug/Connector Type	Conductor Size	Hole Size (HS)	Length (L)	Width (W)
PKS18512H	715123	Heavy-Duty DIN46235	185 mm <sup>2</sup> Stranded, 350 kcmil Stranded	13mm	98mm	37mm
RKS7012T	716656	Standard	2/0 Stranded, 70 mm <sup>2</sup> Stranded	13mm	59mm	23mm
RKS12012H	715121	Standard	120 mm <sup>2</sup> Stranded, 250 kcmil Stranded	13mm	65mm	28mm
PKS1612H	715111	Heavy-Duty DIN46235	#5 Stranded, 16 mm <sup>2</sup> Stranded	13mm	49mm	18mm
RKS050019H	716546	Standard	300 mm <sup>2</sup> Stranded, 600 kcmil Stranded	13mm	109mm	43mm
RKS24012H	716544	Standard	240 mm <sup>2</sup> Stranded, 500 kcmil Stranded	13mm	83mm	39mm
RKS18512T	716662	Standard	185 mm <sup>2</sup> Stranded, 350 kcmil Stranded	13mm	83mm	35mm
RKS15012T	716660	Standard	150 mm <sup>2</sup> Stranded, 300 kcmil Stranded	13mm	72mm	31mm
RKS3512T	716654	Standard	#2 Stranded, 35 mm <sup>2</sup> Stranded	13mm	51mm	21mm
PKS24012H	715127	Heavy-Duty DIN46235	240 mm <sup>2</sup> Stranded, 500 kcmil Stranded	13mm	108mm	42mm
RKS1612T	716652	Standard	#5 Stranded, 16 mm <sup>2</sup> Stranded	13mm	45mm	19mm
RKS9512T	716657	Standard	4/0 Stranded, 95 mm <sup>2</sup> Stranded	13mm	62mm	26mm
RKS612T	716650	Standard	6 mm <sup>2</sup> Stranded	13mm	41mm	19mm
PKS24016H	715128	Heavy-Duty DIN46235	240 mm <sup>2</sup> Stranded, 500 kcmil Stranded	15mm	111mm	42mm
PKS15016H	715122	Heavy-Duty DIN46235	150 mm <sup>2</sup> Stranded, 300 kcmil Stranded	15mm	97mm	34mm

CatalogNumber	Article Number	Lug/Connector Type	Conductor Size	Hole Size (HS)	Length (L)	Width (W)
PKS18516H	715124	Heavy-Duty DIN46235	185 mm <sup>2</sup> Stranded, 350 kcmil Stranded	15mm	101mm	37mm
PKS30020H	715136	Heavy-Duty DIN46235	300 mm <sup>2</sup> Stranded, 600 kcmil Stranded	15mm	119mm	46mm
PKS12014H	715116	Heavy-Duty DIN46235	120 mm <sup>2</sup> Stranded, 250 kcmil Stranded	15mm	88mm	32mm
PKS40020H	715138	Heavy-Duty DIN46235	400 mm <sup>2</sup> Stranded, 800 kcmil Stranded	15mm	140mm	54mm
PKS30016H	715129	Heavy-Duty DIN46235	300 mm <sup>2</sup> Stranded, 600 kcmil Stranded	17mm	119mm	46mm
PKS40016H	715137	Heavy-Duty DIN46235	400 mm <sup>2</sup> Stranded, 800 kcmil Stranded	17mm	140mm	54mm
RKS15016T	716661	Standard	150 mm <sup>2</sup> Stranded, 300 kcmil Stranded	17mm	72mm	31mm
RKS9516T	716658	Standard	4/0 Stranded, 95 mm <sup>2</sup> Stranded	17mm	66mm	26mm
RKS24016T	716664	Standard	240 mm <sup>2</sup> Stranded, 500 kcmil Stranded	17mm	93mm	39mm
RKS18516T	716663	Standard	185 mm <sup>2</sup> Stranded, 350 kcmil Stranded	17mm	83mm	35mm
RKS40016T	716666	Standard	400 mm <sup>2</sup> Stranded, 800 kcmil Stranded	17mm	114mm	49mm
RKS12016T	716659	Standard	120 mm <sup>2</sup> Stranded, 250 kcmil Stranded	17mm	67mm	28mm
RKS30016T	716665	Standard	300 mm <sup>2</sup> Stranded, 600 kcmil Stranded	17mm	101mm	43mm

Table 2/2

Catalog Number	Article Number	Tool/Die Type
PKS5010H	715113	M2M or M2H/PKM2, M3H or M3B/PKM3, MLB/PKML

Catalog Number	Article Number	Tool/Die Type
PKS1610H		M2M or M2H/RKM2, M3H or M3B/RKM3, MLB/RKML
RKS2512T	716653	M2M or M2H/RKM2, M3H or M3B/RKM3, MLB/RKML
PKS18512H	715123	M2M or M2H/PKM2, M3H or M3B/PKM3, MLB/PKML
RKS7012T	716656	M2M or M2H/RKM2, M3H or M3B/RKM3, MLB/RKML
RKS12012H	715121	M2M or M2H/RKM2, M3H or M3B/RKM3, MLB/RKML
PKS1612H	715111	M2M or M2H/PKM2, M3H or M3B/PKM3, MLB/PKML
RKS050019H	716546	M2M or M2H/RKM2, M3H or M3B/RKM3
RKS24012H	716544	M2M or M2H/RKM2, M3H or M3B/RKM3, MLB/RKML
RKS18512T	716662	M2M or M2H/RKM2, M3H or M3B/RKM3, MLB/RKML
RKS15012T	716660	M2M or M2H/RKM2, M3H or M3B/RKM3, MLB/RKML
RKS3512T	716654	M2M or M2H/RKM2, M3H or M3B/RKM3, MLB/RKML
PKS24012H	715127	M2M or M2H/PKM2, M3H or M3B/PKM3
RKS1612T	716652	M2M or M2H/RKM2, M3H or M3B/RKM3, MLB/RKML
RKS9512T	716657	M2M or M2H/RKM2, M3H or M3B/RKM3, MLB/RKML
RKS612T	716650	M2M or M2H/RKM2, MLB/RKML
PKS24016H	715128	M2M or M2H/PKM2, M3H or M3B/PKM3
PKS15016H	715122	M2M or M2H/PKM2, M3H or M3B/PKM3, MLB/PKML
PKS18516H	715124	M2M or M2H/PKM2, M3H or M3B/PKM3, MLB/PKML
PKS30020H	715136	M2M or M2H/PKM2, M3H or M3B/PKM3
PKS12014H	715116	M2M or M2H/PKM2, M3H or M3B/PKM3, MLB/PKML
PKS40020H	715138	M4FP/PKM4, MLB

Catalog Number	Article Number	Tool/Die Type
PKS30016H	715129	M2M or M2H/PKM2, M3H or M3B/PKM3
PKS40016H	715137	M4FP/PKM4
RKS15016T	716661	M2M or M2H/RKM2, M3H or M3B/RKM3, MLB/RKML
RKS9516T	716658	M2M or M2H/RKM2, M3H or M3B/RKM3, MLB/RKML
RKS24016T	716664	M2M or M2H/RKM2, M3H or M3B/RKM3, MLB/RKML
RKS18516T	716663	M2M or M2H/RKM2, M3H or M3B/RKM3, MLB/RKML
RKS40016T	716666	M3H or M3B/RKM3
RKS12016T	716659	M2M or M2H/RKM2, M3H or M3B/RKM3, MLB/RKML
RKS30016T	716665	M2M or M2H/RKM2, M3H or M3B/RKM3

## DIAGRAMS

---

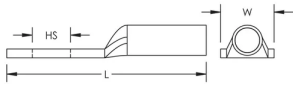

## WARNING

---

nVent products shall be installed and used only as indicated in nVent's product instruction sheets and training materials. Instruction sheets are available at [www.nvent.com](http://www.nvent.com) and from your nVent customer service representative. Improper installation, misuse, misapplication or other failure to completely follow nVent's instructions and warnings may cause product malfunction, property damage, serious bodily injury and death and/or void your warranty.



Our powerful portfolio of brands:

**CADDY   ERICO   HOFFMAN   ILSCO   SCHROFF   TRACHTE**