

1 Hole Offset Lug

Data Solutions



FEATURES

Provides an efficient bolting surface for grounding and power applications

Electrolytic grade copper

For use with nVent ERICO Cadweld type LA connections only

SPECIFICATIONS

Material: Copper

Finish: Tinned

Table 1/2

Catalog Number	Type	Height (H)	Length (L)	Width (W)	Thickness (T)	A
B101CEOL	NEMA®	0.63in	2.5in	1in	0.12in	0.5in
B305TC	Non-NEMA®	0.79in	3.6in	1.18in	0.2in	0.59in

Table 2/2

Catalog Number	B	C	Hole Size (HS)	Angle (a)	Equivalent Conductor Size
B101CEOL	1in	0.88in	0.44in	45°	159.12kcmil
B305TC	1.33in	1.57in	0.67in	45°	300.43kcmil

ADDITIONAL PRODUCT DETAILS

For sizes not listed, contact us.

DIAGRAMS

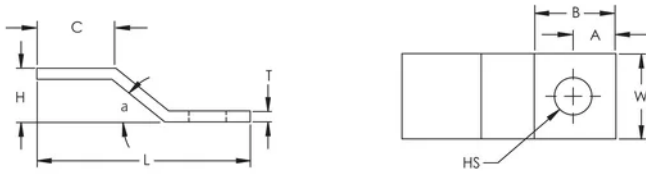

WARNING

nVent products shall be installed and used only as indicated in nVent's product instruction sheets and training materials. Instruction sheets are available at www.nvent.com and from your nVent customer service representative. Improper installation, misuse, misapplication or other failure to completely follow nVent's instructions and warnings may cause product malfunction, property damage, serious bodily injury and death and/or void your warranty.



Our powerful portfolio of brands:

CADDY ERICO HOFFMAN ILSCO SCHROFF TRACHTE