

# IBSHY geïsol. gevlocht. geleider voor compacte stroomonderbrekers, 160 A, 365 mm

## Data Solutions

### CATALOGUSNUMMER

---

### IBSHY32-365

IBSHY is the ideal ready-to-install flexible wire replacement solution that is specifically designed for connections from compact molded case circuit breakers with typical current rating of 125/160 A to copper busbar. The IBSHY connects to the front access terminals of the breakers without any additional accessories, such as angular connectors, spreaders, ring terminal connectors or extenders. IBSHY is available in cross section of 32 mm<sup>2</sup> (63.15 kcmil), lengths from 230 to 830 mm (9.1" to 32.7").

Manufactured in an ISO 9001 2015 certified proprietary automated facility, IBSHY is formed by weaving high-quality electrolytic copper wire to form a durable low voltage connector with maximum flexibility that allows for more compact power connections to circuit breakers. The IBSHY allows users to reduce the total size and weight of the installation, improving both design flexibility and assembly aesthetics.

The IBSHY features integral pre-punched palms at one end with a pre-punched crimped tube at the other end both of which are ready to connect out of the box. There are no lugs to purchase or install, making connections simpler and faster and eliminating faulty connections due to vibration or fatigue.

These specific shapes give users the advantage to have the possibility to link a compact circuit breaker, or other apparatus, using connection by cage or bolt to a copper busbar with a larger bolt.

The insulation is a high-resistance, self-extinguishing, and halogen free glass fiber reinforced silicone providing possible high working temperature. IBSHY is compatible with all major brand compact molded case circuit breakers with 125/160 A nominal current. Contact your nVent ERIFLEX representative to determine the correct size for your application.



## CERTIFICERINGEN

---



## KENMERKEN

---

Snelle en gemakkelijke installatie

RoHS-conform

Suitable for all main 125/160 A electrical devices and specifically molded case circuit breakers

Resistant to vibration, improving reliability and performance

Improves assembly flexibility and aesthetics

No additional cutting, stripping, crimping and punching needed

Small wire diameter provides maximum flexibility

Halogen free solution for applications requiring a low smoke solution

Conforms to NF EN 45545 obtaining an HL3 classification for chapters R22 and R23

DNV GL® certified for marine and offshore applications

High working temperature

## PRODUCTKENMERKEN

---

Artikelnummer: 558587

Nominale stroom standaardtoepassing: 160A

Afwerking: Vertind

Materiaal: Koper; Met glasvezel versterkt siliconen

Ontvlambaarheidsklasse: UL® 1441 VW-1

Max. bedrijfsspanning, IEC (Ui): 1000; 1500

Piekkortsluitstroom (Ipk): 15kA

Draaddiameter: 0.15mm

Werktemperatuur: -60 to 250°C

Voldoet aan: IEC® 60439,1; IEC® 61439,1

Dwarsprofiel: 32mm<sup>2</sup>

Lengte (L): 365mm

A: 11mm

B: 25mm

C: 3mm

D: 5mm

Gatgrootte 1 (HS1): 6.5mm

Gatgrootte 2 (HS2): 10.5mm

Gewicht eenheid: 0.11kg

## AANVULLENDE PRODUCTGEGEVENS

$\Delta T$  = Leittertemperatuur – Innentemperatuur des Schaltschranks.

Deze tabel geeft de temperatuurstijging met de betreffende stroomsterkte en de overeenkomstige doorsnede. Deze berekening houdt niet rekening met de warmteafgifte van het schakelapparaat.

| Maximum Ampacity Ratings               |                      |                      |                      |                      |                      |                      |                      |                      |                      |                      |                      |                       |                       |                              |                              |
|--|----------------------|----------------------|----------------------|----------------------|----------------------|----------------------|----------------------|----------------------|----------------------|----------------------|----------------------|-----------------------|-----------------------|------------------------------|------------------------------|
| Cross Section (mm <sup>2</sup> /kcmil) | $\Delta T$ 30° C (A) | $\Delta T$ 35° C (A) | $\Delta T$ 40° C (A) | $\Delta T$ 45° C (A) | $\Delta T$ 50° C (A) | $\Delta T$ 55° C (A) | $\Delta T$ 60° C (A) | $\Delta T$ 65° C (A) | $\Delta T$ 70° C (A) | $\Delta T$ 75° C (A) | $\Delta T$ 80° C (A) | $\Delta T$ 100° C (A) | $\Delta T$ 120° C (A) | 2 stang stroo mcoë fficie nt | 3 stang stroo mcoë fficie nt |
|  | 32/63,15             | 142                  | 153                  | 164                  | 174                  | 184                  | 193                  | 201                  | 209                  | 217                  | 225                  | 235                   | 263                   | 290                          | 1,6                          |

| Circuit Breaker Compatibility      |                        |
|------------------------------------|------------------------|
| Circuit Breaker Current Rating     | 125/160 A              |
| Referentienummer                   | IBSHY32x               |
| Schneider Electric® Compact® (IEC) | NSA NG 125             |
| Square D® PowerPact® (UL)          | H-Frame                |
| ABB® Tmax® (IEC)                   | T1 T2 XT1 XT2          |
| ABB® Tmax® (UL)                    | T1 T2 XT1 XT2          |
| GE® Record Plus® (IEC/UL)          | FD 160                 |
| Siemens® Sentron® (IEC/UL)         | VL160X 3VL1 VL160 3VL2 |
| Moeller® xEnergy® (IEC)            | NZM1                   |
| Cutler Hammer® Series G (UL)       | EG Frame               |
| Legrand® (IEC)                     | DPX 160 DPX3 160       |
| Hager® (IEC)                       | h3 160                 |
| Rockwell/Allen Bradley (UL)        | G-Frame H-Frame        |
| OEZ (IEC)                          | BC160N                 |

## DIAGRAMMEN

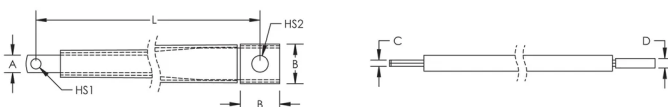

## WAARSCHUWING

nVent-producten moeten alleen worden geïnstalleerd en gebruikt zoals aangegeven in de instructiebladen en trainingsmateriaal van nVent. Instructiebladen zijn beschikbaar op [www.nvent.com](http://www.nvent.com) en bij uw nVent

klantenservicevertegenwoordiger. Onjuiste installatie, misbruik, verkeerde toepassing of ander falen om de instructies en waarschuwingen van nVent volledig te volgen, kan leiden tot productstoringen, schade aan eigendommen, ernstig lichamelijk letsel en de dood en/of uw garantie ongeldig maken.



Ons krachtige merkenportfolio:

**CADDY   ERICO   HOFFMAN   ILSCO   SCHROFF   TRACHTE**

©2026 nVent. Alle nVent-merken en -logo's zijn eigendom van of in licentie gegeven door nVent Services GmbH of haar gelieerde ondernemingen. Alle andere handelsmerken zijn het eigendom van hun respectieve eigenaren. nVent behoudt zich het recht voor om specificaties zonder kennisgeving te wijzigen.

Dit document is door het systeem gegenereerd.