

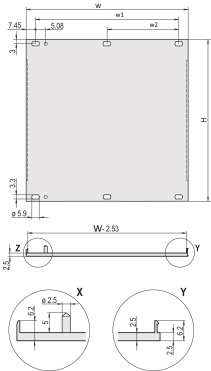

U???????????



??



??

U ?, ???, ?, 2.5 mm, ??????, ????

?? EMC ????

????

- (D): 2.5mm
- :
- :
- :
- :
- :
- EMC □□ :

Table 1/3

□□□	□□□□	□□□□	□□□□	□□	□□□□	□□□□□□
30848-385	3U	9HP	1	□□□□□□	□□ EMC	□□□□
30848-354	3U	4HP	1	□□□□□□	□□ EMC	□□□□

Part Number	Height	Power	Units	Weight	EMC	Notes
20848-120	6U	28HP	1	10.0kg	EMC	
30848-387	6U	10HP	1	10.0kg	EMC	
20848-047	3U	42HP	1	10.0kg	EMC	
20848-139	6U	42HP	1	10.0kg	EMC	
20848-650	5U	84HP	1	10.0kg	EMC	
30848-381	6U	6HP	1	10.0kg	EMC	
30848-386	3U	10HP	1	10.0kg	EMC	
20848-160	6U	63HP	1	10.0kg	EMC	
20848-649	5U	63HP	1	10.0kg	EMC	
20848-269	4U	42HP	1	10.0kg	EMC	
30848-380	3U	6HP	1	10.0kg	EMC	
20848-206	2U	28HP	1	10.0kg	EMC	
30848-382	3U	7HP	1	10.0kg	EMC	
20848-270	4U	42HP	1	10.0kg	EMC	
20848-648	5U	42HP	1	10.0kg	EMC	
20848-262	2U	84HP	1	10.0kg	EMC	
20848-027	3U	28HP	1	10.0kg	EMC	
30848-384	3U	9HP	1	10.0kg	EMC	

Table 2/3

Part Number	Height	Power	Units	Weight	EMC	Notes
20848-647	5U	28HP	1	10.0kg	EMC	
20848-268	4U	28HP	1	10.0kg	EMC	
30848-383	6U	7HP	1	10.0kg	EMC	
20848-280	9U	84HP	1	10.0kg	EMC	
30848-357	6U	8HP	1	10.0kg	EMC	
20848-068	3U	63HP	1	10.0kg	EMC	
20848-260	2U	42HP	1	10.0kg	EMC	
20848-013	3U	14HP	1	10.0kg	EMC	
30848-359	6U	12HP	1	10.0kg	EMC	
30849-005	6U	3HP	1	10.0kg	EMC	
20848-189	6U	84HP	1	10.0kg	EMC	
20848-015	3U	16HP	1	10.0kg	EMC	
30848-378	3U	5HP	1	10.0kg	EMC	
20848-020	3U	21HP	1	10.0kg	EMC	

Part No.	Height	Power	Quantity	Dimensions	EMC	RoHS
30849-004	3U	3HP	1	261.8mm	EMC	RoHS
30848-358	3U	12HP	1	261.8mm	EMC	RoHS
20848-106	6U	14HP	1	261.8mm	EMC	RoHS
30848-379	6U	5HP	1	261.8mm	EMC	RoHS
20848-108	6U	16HP	1	261.8mm	EMC	RoHS
30849-002	6U	2HP	1	261.8mm	EMC	RoHS

Table 3/3

Part No.	Height	Power	Quantity	Dimensions	EMC	RoHS
30848-356	3U	8HP	1	261.8mm	EMC	RoHS
20848-097	3U	84HP	1	261.8mm	EMC	RoHS
20848-271	4U	84HP	1	261.8mm	EMC	RoHS
30848-355	6U	4HP	1	261.8mm	EMC	RoHS
20848-113	6U	21HP	1	261.8mm	EMC	RoHS
20848-261	2U	63HP	1	261.8mm	EMC	RoHS
30849-001	3U	2HP	1	261.8mm	EMC	RoHS

Table 1/3

Part No.	Height	Power	Standard	Height (H)	Width (W)	RoHS
30848-385	3U	3HP	IEC 60297-3-101, IEEE 1101.1/10	261.8mm	45.38mm	
30848-354	3U	12HP	IEC 60297-3-101, IEEE 1101.1/10	128.4mm	20mm	RoHS
20848-120	6U	14HP	IEC 60297-3-101, IEEE 1101.1/10	261.8mm	141.9mm	RoHS
30848-387	6U	5HP	IEC 60297-3-101, IEEE 1101.1/10	261.8mm	50.5mm	RoHS
20848-047	6U	16HP	IEC 60297-3-101, IEEE 1101.1/10	128.4mm	213mm	RoHS
20848-139	6U	16HP	IEC 60297-3-101, IEEE 1101.1/10	261.8mm	213mm	RoHS
20848-650	6U	2HP	IEC 60297-3-101, IEEE 1101.1/10	217.4mm	426.4mm	

Part No.	Part Name	Part Description	Part No.	Height (H)	Width (W)	RoHS
30848-381	30848-381	30848-381	IEC 60297-3-101, IEEE 1101.1/10	261.8mm	30.1mm	RoHS
30848-386	30848-386	30848-386	IEC 60297-3-101, IEEE 1101.1/10	128.4mm	50.5mm	RoHS
20848-160	20848-160	20848-160	IEC 60297-3-101, IEEE 1101.1/10	261.8mm	319.7mm	RoHS
20848-649	20848-649	20848-649	IEC 60297-3-101, IEEE 1101.1/10	217.4mm	319.7mm	
20848-269	20848-269	20848-269	IEC 60297-3-101, IEEE 1101.1/10	172.9mm	213mm	RoHS
30848-380	30848-380	30848-380	IEC 60297-3-101, IEEE 1101.1/10	128.4mm	30.1mm	RoHS
20848-206	20848-206	20848-206	IEC 60297-3-101, IEEE 1101.1/10	84mm	141.9mm	
30848-382	30848-382	30848-382	IEC 60297-3-101, IEEE 1101.1/10	128.4mm	35.2mm	RoHS
20848-270	20848-270	20848-270	IEC 60297-3-101, IEEE 1101.1/10	172.9mm	213mm	RoHS
20848-648	20848-648	20848-648	IEC 60297-3-101, IEEE 1101.1/10	217.4mm	213mm	
20848-262	20848-262	20848-262	IEC 60297-3-101, IEEE 1101.1/10	84mm	426.4mm	RoHS
20848-027	20848-027	20848-027	IEC 60297-3-101, IEEE 1101.1/10	128.4mm	141.9mm	RoHS
30848-384	30848-384	30848-384	IEC 60297-3-101, IEEE 1101.1/10	128.4mm	45.38mm	

Table 2/3

Part No.	Part Name	Part Description	Part No.	Height (H)	Width (W)	RoHS
----------	-----------	------------------	----------	------------	-----------	------

20848-647	☐☐	☐	IEC 60297-3-101, IEEE 1101.1/10	217.4mm	141.9mm	
20848-268	☐☐	☐	IEC 60297-3-101, IEEE 1101.1/10	172.9mm	141.9mm	RoHS
30848-383	☐☐	☐	IEC 60297-3-101, IEEE 1101.1/10	261.8mm	35.2mm	RoHS
20848-280	☐☐	☐	IEC 60297-3-101, IEEE 1101.1/10	395.1mm	426.4mm	RoHS
30848-357	☐☐	☐	IEC 60297-3-101, IEEE 1101.1/10	261.8mm	40.3mm	RoHS
20848-068	☐☐	☐	IEC 60297-3-101, IEEE 1101.1/10	128.4mm	319.7mm	RoHS
20848-260	☐☐	☐	IEC 60297-3-101, IEEE 1101.1/10	84mm	213mm	
20848-013	☐☐	☐	IEC 60297-3-101, IEEE 1101.1/10	128.4mm	70.8mm	RoHS
30848-359	☐☐	☐	IEC 60297-3-101, IEEE 1101.1/10	261.8mm	60.6mm	RoHS
30849-005	☐☐	☐	IEC 60297-3-101, IEEE 1101.1/10	261.8mm	14.9mm	
20848-189	☐☐	☐	IEC 60297-3-101, IEEE 1101.1/10	261.8mm	426.4mm	RoHS
20848-015	☐☐	☐	IEC 60297-3-101, IEEE 1101.1/10	128.4mm	80.9mm	RoHS
30848-378	☐☐	☐	IEC 60297-3-101, IEEE 1101.1/10	128.4mm	25mm	RoHS
20848-020	☐☐	☐	IEC 60297-3-101, IEEE 1101.1/10	128.4mm	106.3mm	RoHS
30849-004	☐☐	☐	IEC 60297-3-101, IEEE 1101.1/10	128.4mm	14.9mm	RoHS

30848-358	□□	□	IEC 60297-3-101, IEEE 1101.1/10	128.4mm	60.6mm	RoHS
20848-106	□□	□	IEC 60297-3-101, IEEE 1101.1/10	261.8mm	70.8mm	RoHS
30848-379	□□	□	IEC 60297-3-101, IEEE 1101.1/10	261.8mm	25mm	RoHS
20848-108	□□	□	IEC 60297-3-101, IEEE 1101.1/10	261.8mm	80.9mm	RoHS
30849-002	□□	□	IEC 60297-3-101, IEEE 1101.1/10	261.8mm	9.8mm	RoHS

Table 3/3

□□□	□□□□□□	□□□□	□□	□□ (H)	□□ (W)	□□
30848-356	□□	□	IEC 60297-3-101, IEEE 1101.1/10	128.4mm	40.3mm	RoHS
20848-097	□□	□	IEC 60297-3-101, IEEE 1101.1/10	128.4mm	426.4mm	RoHS
20848-271	□□	□	IEC 60297-3-101, IEEE 1101.1/10	172.9mm	426.4mm	RoHS
30848-355	□□	□	IEC 60297-3-101, IEEE 1101.1/10	261.8mm	20mm	RoHS
20848-113	□□	□	IEC 60297-3-101, IEEE 1101.1/10	261.8mm	106.3mm	RoHS
20848-261	□□	□	IEC 60297-3-101, IEEE 1101.1/10	84mm	319.7mm	
30849-001	□□	□	IEC 60297-3-101, IEEE 1101.1/10	128.4mm	9.8mm	RoHS

??????

????????????????????

2 ... 12 HP ? 14 ... 84 HP ????????

2 ...12 HP????U?

